

Woodlands Park Area

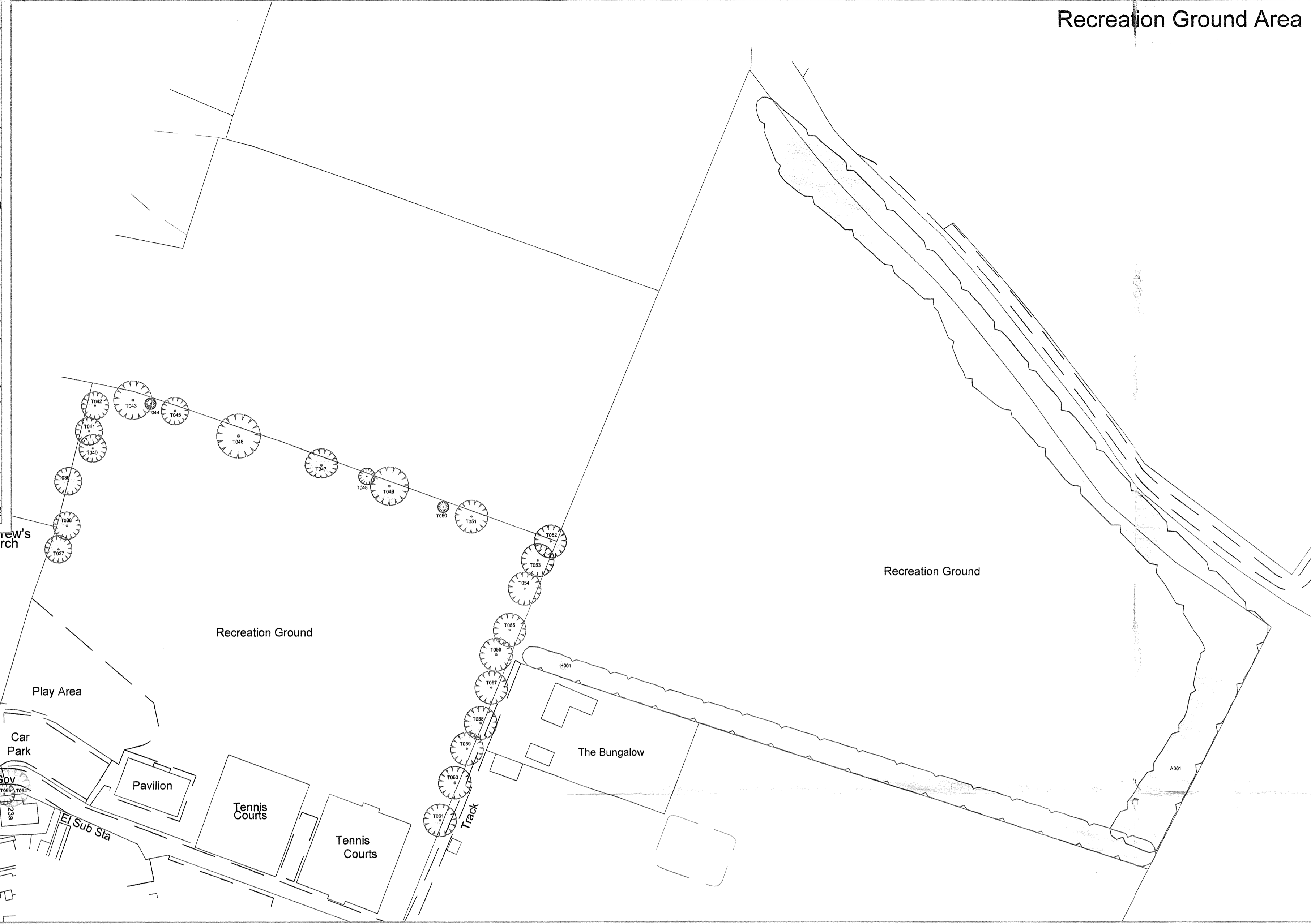

Recreation Ground Area



CATEGORY AND DEFINITION

Category A	Those of high quality and Value; in such condition as to be able to make a substantial contribution (a minimum of 40 years is suggested)
Category B	Those of moderate quality and Value; those in such condition as to make a significant contribution (a minimum of 20 years is suggested)
Category C	Those of low quality and Value; currently in adequate condition to remain until new planting could be established (a minimum of 10 years is suggested); or young trees with a stem diameter below 150mm
Category R	Those in such condition that any existing value would be lost within 10 years and which should, in the current context, be removed for reasons of sound arboricultural management

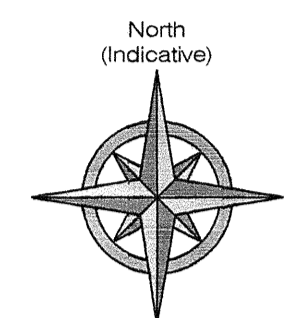

LEGEND

	Existing Tree/Hedge BS 5837:2005 Category A
	Existing Tree/Hedge BS 5837:2005 Category B
	Existing Tree/Hedge BS 5837:2005 Category C

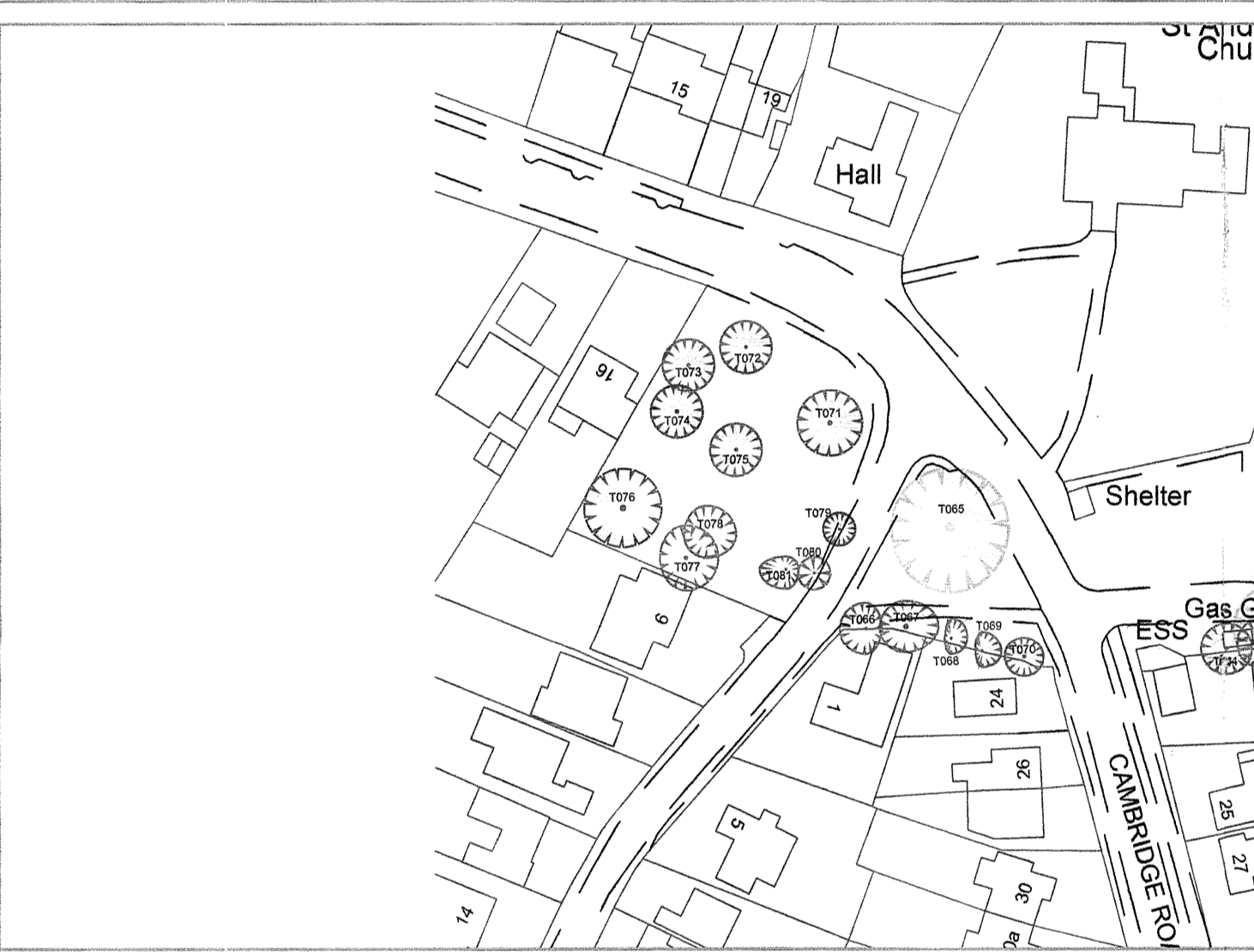

Woody Green Area

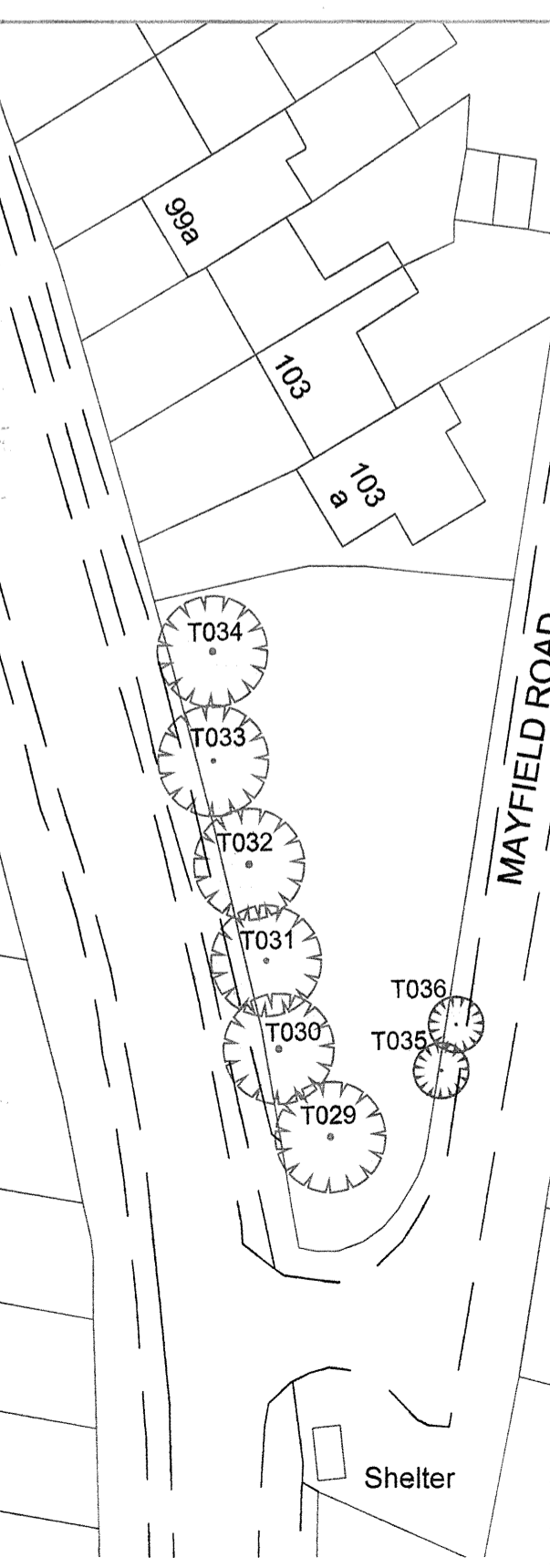

Mayfield Road Area

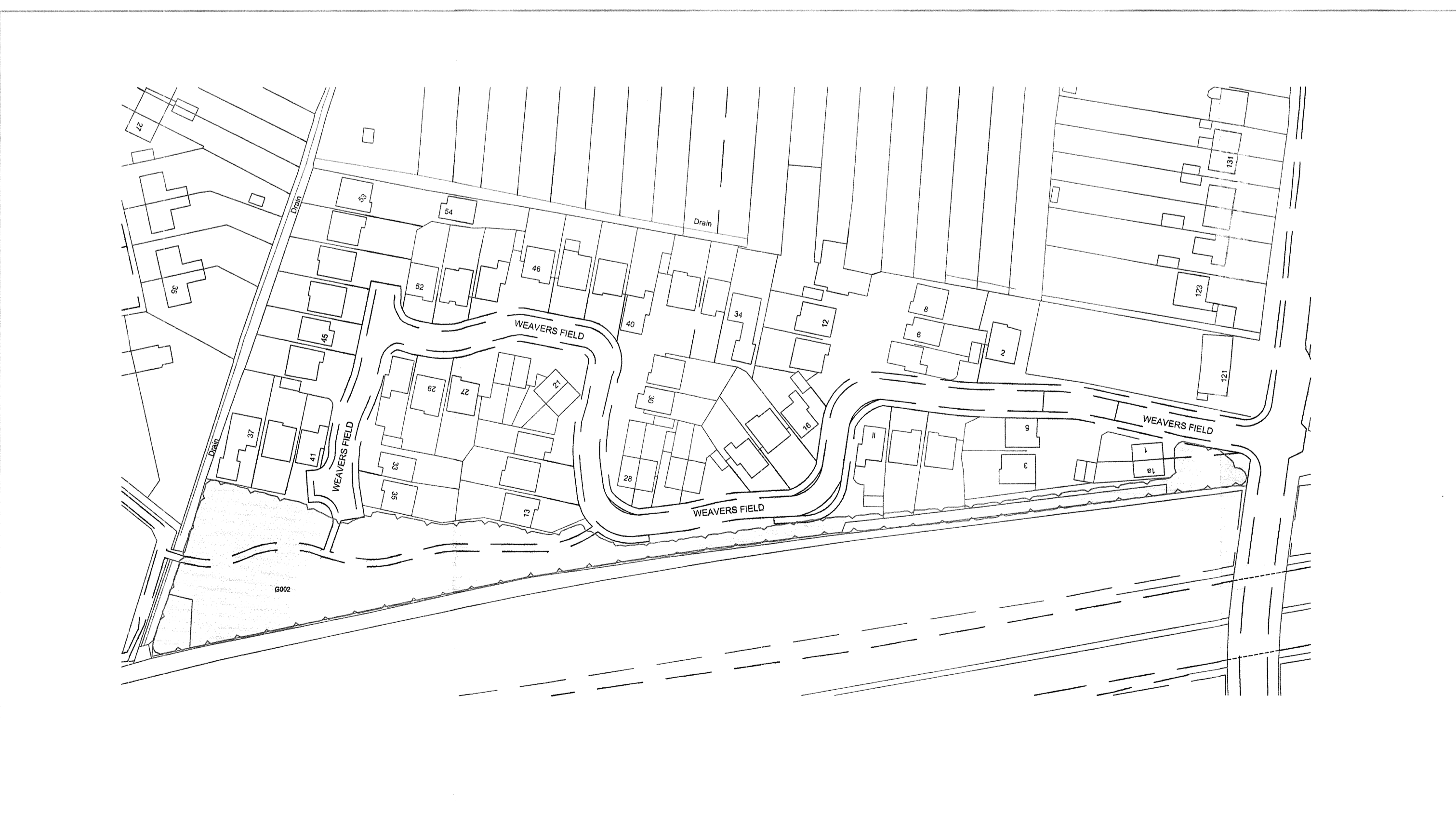

Weavers Field Area

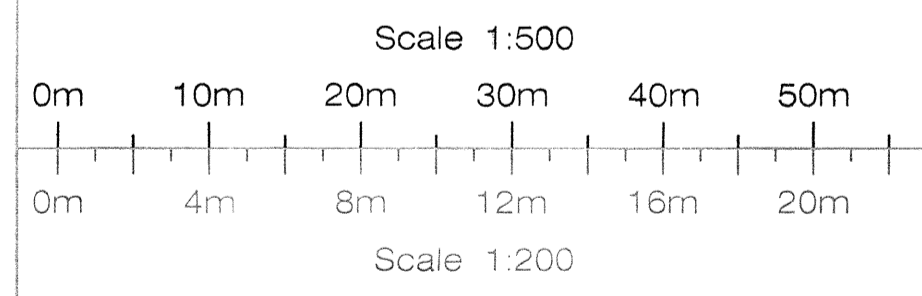

© HAYDEN'S 2008
 5 Moseleys Farm Business Centre
 Fornham All Saints, Bury St Edmunds Suffolk IP28 6JY
 Tel: 01284 765391 Fax: 01284 765181 Mobile: 07850 167400
 Web Page: www.treesurveys.co.uk Email: info@treesurveys.co.uk
 Client: Girtton Parish Council Drawing Title: Tree Survey
 Site: Girtton Parish Council Sites
 Date: 12/10/08 Drawn By: AWG Cad File Ref: C:\Pro\1544.D.TS GirttonParishSites.dwg
 Scale: 1:1000 @ A1 Checked By: HC Drawing No: 1544.D Rev: -