



# GIRTON

## Parish News

May 2026



Remembering Louie  
- see page 28

Bluebells in bloom



**GIRTON**  
DENTAL PRACTICE  
your local dentist

**PRIVATE GENERAL DENTISTRY  
DENTAL EMERGENCIES  
HYGIENE AND WHITENING**

**Monday to Saturday 9:00am to 5:00pm**

Evenings & Weekends Available on Request

**Accepting New Patients**

Scan QR Code for online registration

Call  
Clinic: 01223 928 434  
For Emergency: 07470998199  
enquiry@girtondentalpractice.co.uk

www.girtondentalpractice.co.uk

8 Thornton Way, Girton,  
Cambridge CB3 0NJ

**IT'S THE GEORGE  
PUB QUIZ**

£2 per Person  
7.30 start!

LATE ARRIVALS  
LOOSE POINTS!

*So let's get quizzical*

**MAXIMUM OF SIX  
PEOPLE PER TEAM**  
Limited Space  
Booking Advisable

PRESS  
BUTTON  
TO  
ACTIVATE

**TUESDAY 19th MAY at The George, Girton**  
71 High Street, Girton, GB CB3 0QD ☎ 01223 276197

### Local support service available

I have 30 years experience in community care and am also qualified to teach exercise and fitness, so can help with mobilizing and gentle routines for gaining confidence and maintaining your independence.

We also offer assistance with domestic tasks, community access, health appointments etc.

References available.

To find out more please contact Martin

e-mail : martinjones333@hotmail.com

Tel: 01223 501922

## Agewell Osteopathy Clinic

“Keeping you as active and strong as possible”



28 Woodlands Park, Girton.

www.agewellosteopathy.com

Email: Clinic@agewellosteopathy.com

Mobile: 07746 173007

Matthew Courtney-Jones: qualified in 1996. Girton resident since 2000

Helping with joint and muscle pain, strength and mobility

Consultation by appointment only.

## Publication Information

**Editor:** Rob Neal, 101 High St., CB3 0QQ, tel. 07875 374966,

email [editorgirtonparishnews@gmail.com](mailto:editorgirtonparishnews@gmail.com)

**Secretary:** Sheila Bowler, tel. 276914

**Advertising Manager and Treasurer:** Marion Fisher, 117 High St, CB3 0QQ, tel. 570866, email [gpnads@girton-cambs.org.uk](mailto:gpnads@girton-cambs.org.uk)

Copy should be submitted to the Editor in electronic form, with any photos, graphics or logos submitted as separate attachments, not embedded in the file. Questions about submission should be addressed to the Editor.

The editorial team reserves the right to edit, accept or reject any material submitted for publication. The views expressed within the magazine are those of the contributors and do not necessarily reflect those of the editorial team.

A copy of the magazine is available on the Girton website at [www.girton-cambs.org.uk](http://www.girton-cambs.org.uk), where you may also find expanded versions of selected items.

### Advertisements

Prices for placing advertisements in the *Girton Parish News*, in black-and-white or colour, can be had on application to the Advertising Manager.

The advertising policy of the *Girton Parish News* aims to promote enterprises and activities from within Girton. The space available for advertisements is limited, and preference is given to businesses founded, situated, controlled and operated within Girton. The *Girton Parish News* reserves the right to decline to publish any advertisement which the Advertising Manager considers not to meet the objectives of this policy. Inclusion of an advertisement does not imply endorsement by the *Girton Parish News* of the product or service advertised.

**The *Girton Parish News* is produced and distributed entirely by volunteers from the village, including the following:**

*Typesetters* Claire Lightley, Shahila Mitchell, Bill Rothwell.

*Distribution Coordinator* Karen Richardson  
email: [gpndist@gmail.com](mailto:gpndist@gmail.com)

*Editors and Proofreaders* Chris Bowler, Mike Fay, Marion Fisher, John Gibson, Alison Giles, Carol Huxley, Michelle Jones, Mary Rodger, Kate Rothwell, Patsy Smith, Matthew Vernon.

*Puzzle Corner* Sian Franklin

*Webmaster* Andrew Haylett,

and many others. If you are interested in becoming involved in any capacity, please contact the Editor.

Printed by *Printerbello Ltd, Girton, Cambridge*  
Tel: 01223 855195

## GIRTON FEAST VILLAGE FETE

**SATURDAY 11<sup>TH</sup> JULY**

**FROM 11am ONWARDS - FREE ENTRY**

VENUE: GIRTON RECREATION GROUND, CBE 0FH

**ENTERTAINMENT FOR THE WHOLE FAMILY**

*SCHOOL CHOIR - LOCAL BANDS -  
CHILDREN'S ENTERTAINER - CHILDREN'S  
DISCO - ROCK CHOIR*



### New this year!

Have – a- go Maypole dancing.  
Come and join in the fun, everyone  
welcome  
Practice session on the recreation ground  
on Saturday 4<sup>th</sup> July at 10.30am

**BEER TENT**  
Pizza Passione  
Wrapunzel  
Smokehouse  
burgers  
Slush puppies  
Purple Pepper  
Churros

**Please book  
your stall by  
contacting  
Carol@girton  
feast.org.uk**

**SPORTS:**  
FAMILY FUN RUN  
HAVE A GO TENNIS  
BEAT THE GOALIE  
TABLE TENNIS  
TOURNAMENT  
TARGET BOWLS  
GOLF PUTTING

All the information about this year's Girton Feast on  
our NEW website: [www.girtonfeast.org.uk](http://www.girtonfeast.org.uk)

## Contents

Pages 5–9	Parish Council and Councillors' Reports
Page 7	Girton Glebe
Page 11	Forthcoming Events
Page 13	Gretton School
Page 15	Gardening
Page 17	Girton Scoreboard
Page 18	Girton Musical Theatre
Page 19	Feast Week
Pages 20–21	Girton Town Charity
Page 23	Puzzle Corner
Page 25	WI and Club 55
Page 26	Friends of the Rosie
Page 27	Listening Lantern and Walking Group
Page 28	Tribute to Louie Holliday
Page 29	Our Churches
Page 30	Bins and Mobile Library

**Copy date for June 2026 issue: Wed. 13 May. Issue date: Sat 30 May. Covers 30 May – 27 June.**



**Girton Framers**

Local bespoke picture framing service

 [www.girtonframers.co.uk](http://www.girtonframers.co.uk)  
 [contact@girtonframers.co.uk](mailto:contact@girtonframers.co.uk)  
 01223 635249







**Osteopathy & Sports Massage**

Back Pain  
 Neck & Shoulder Pain  
 Sciatica  
 Hip & Knee Arthritis  
 Sports Injuries  
 Repetitive Strains  
 Elbow & Wrist Pain  
 Foot & Ankle Pain  
 Jaw Dysfunction  
 Posture Assessment



**Bethany Garrett**  
Registered Osteopath  
Qualified in 2015

 [www.cambridgeosteopathy.co.uk](http://www.cambridgeosteopathy.co.uk)  
 07986 767702  
 [cambridgeosteopathy@gmail.com](mailto:cambridgeosteopathy@gmail.com)  
 Vision Fitness, Oakington Road, Girton, CB3 0QH

## Life Coach and Mentor

*Tired of power struggles with your child/teen?  
Let's bring peace back to your home!*

- ★ Expert guidance for parents and children of all ages to build a strong relationship that lasts a lifetime.
- ★ Turn daily battles into deeper understanding and connection

**ICF Accredited Life Coach**  
**Qualified Psychologist**  
**Retired Teacher**



**Ana Mackrill**

Tel: 07742 117031  
 Email: [anamackrill@gmail.com](mailto:anamackrill@gmail.com)  
 Website: [www.abundantlifecoach.co.uk](http://www.abundantlifecoach.co.uk)



# Girton Social Club

48 Cambridge Road, Girton CB3 0PJ

[girtonsocialclub@gmail.com](mailto:girtonsocialclub@gmail.com) Tel 01223 276890

**A members club  
run by the members  
for the benefit of the members.**



We are a vibrant family orientated social club located in the heart of the village. Our aim is to provide a safe and friendly environment where residents can meet, socialise and make new friends. New members are always welcome so why not come along and be part of our growing community?

For more information please check out our website  
**[girtonsocialclub.com](http://girtonsocialclub.com)**





**ANNUAL MEMBERSHIP:** New £10 Senior £3.50 Education full/part time £3.50 Serving armed forces £1

# Girton Parish Council



## Planning ahead and keeping Girton informed

Girton Parish Council has been continuing work that many residents will recognise as familiar, but which is now coming together in a more deliberate and visible way. Each month brings decisions, consultations and community issues, but we are now on the cusp of something genuinely positive: new roles, a new Parish Council from May, and a stronger focus on early communication, planning and engagement.

This article brings together recent work to explain what we are doing, why it matters, and how residents can engage earlier and more clearly. If you are someone who likes to understand how decisions connect over time, the links we've included in this article are there for you and we invite you to comment on any more you would like to see.

## Communicating earlier and inviting feedback

We are sometimes told that there can be an "information gap" around Parish Council decisions. Rather than reacting defensively, we have treated this as a prompt to improve *when* information is shared and *how* it is connected.

Our intention is to:

- share information earlier, while options are still being shaped
- explain the process and reasoning behind decisions, not just the outcome
- use the Parish Council website as the main reference point, with Facebook and other channels signposting to it rather than fragmenting updates across platforms

When new material is published, we tend to see short bursts of activity on the website. This suggests that residents are using it purposefully to understand what is happening at the point it matters to them.

This approach was prompted in part by questions from one of our residents about the precept-setting process, which led us to publish a detailed audit-trail article explaining how that decision was reached. We intend to take the same approach going forward, with short articles alongside major decisions explaining both process and outcome.

If there is information you would find useful earlier, or if something feels unclear, we genuinely welcome that feedback.

<https://www.girton-pc.gov.uk/news/>

## Precept setting, the Neighbourhood Plan and joined-up decisions

Although the 2026/27 precept was agreed in January, the council has since published detailed information explaining how that decision was reached. This is intentional.

One way in which Girton Parish Council operates differently from many councils is the explicit link between budget decisions and the Neighbourhood Plan. Evidence, priorities and long-term

delivery set out in the plan directly inform how money is allocated and what can realistically be delivered.

This takes time, much of it invisible. Over recent months the council has been responding to three major consultations alongside ongoing Neighbourhood Plan work, budget setting and service delivery. These consultations are not standalone. Together, they shape how decisions will be made, funded and delivered over the next 10–15 years.

We include links to this material not because we expect everyone to read everything at once, but because it matters that residents can see the detail, revisit it over time, and understand how decisions connect.

*Find out more on our consultation responses here:*  
<https://shorturl.at/45xaC>

*Our Neighbourhood Plan information can be found here:*  
<https://shorturl.at/xSmwW>

More information on the precept process will be published on the Parish Council website and Girton Village Community Facebook page.

## Strengthening capacity: Governance & Delivery Officer

One of the most significant decisions taken by the Parish Council this year was the approval of a new Governance & Delivery Officer (GDO) role.

This role represents one of the council's approved major investments this year. It is intended to bring much-needed capacity to Girton Parish Council at a time when the scale and complexity of work is increasing.

The Governance & Delivery Officer is being recruited so that:

- approved projects and proposals can be brought forward earlier, with better information available when agendas are set
- more realistic cost estimates and supporting detail are available before decisions are required
- relationships with suppliers and contractors can be better understood and managed
- engagement with residents can be more proactive, timely and accessible

The timing of the role is deliberate. The intention is for the post-holder to be in place in time to contribute to the approved strategy meeting for the new Parish Council, and to support the job evaluation and organisational work being undertaken with Local Council Consultancy (LCC). This work will help ensure that roles, responsibilities and capacity are aligned with what the Council is actually being asked to deliver.

Put simply, this role is about strengthening the foundations of how the Parish Council works. It supports better planning, clearer information, and a more sustainable way of working as Girton continues to change.

*Continued on page 6...*

**Community facilities, volunteers and long-term stewardship**

The council has been reviewing how community facilities are used, governed and funded. Many arrangements in Girton have developed informally and are sustained by the generosity, commitment and energy of volunteers. That contribution is one of the village’s great strengths and is deeply valued.

At the same time, the council has a duty to ensure facilities are safe, fair to use, and sustainable to maintain. Health and safety requirements, inspections, insurance and long-term maintenance costs are often under-recognised until equipment reaches the end of its life, at which point costs can appear unexpectedly high.

The work now underway is about supporting volunteer effort properly, not relying on it unsustainably, and ensuring facilities can be maintained and improved in a planned and affordable way over time.

**Cricket, the Recreation Ground and future facilities**

Cricket planning is a good example of the council’s approach to early discussion. Working with Girton Cricket Club, Cambridgeshire Cricket and the England and Wales Cricket Board, the council has been considering how best to plan for future demand as participation grows.

We are now at the point where the council will consider whether to confirm the relocation of cricket to the Ten Acre Field. Drawings and supporting information are available on the Parish Council website.

This work also creates an opportunity to consider the future of the wider Recreation Ground, including:

- pitch quality and weather resilience
- the well-used play area
- access and shared use
- how the Pavilion can support wider community activity

Early planning allows health and safety, maintenance capacity and long-term use to be considered together rather than dealt with reactively later. Find out more on our website, under our Plans and Project Section – Girton’s Great Plan:

<https://shorturl.at/Qhvqe>

**Groundsman compound and village-wide support**

A planning application has now been submitted for a groundsman compound at the Recreation Ground and can be viewed on the Greater Cambridge Shared Planning public planning portal.

This is enabling infrastructure. It will allow the Parish Ranger and Groundsman to store equipment safely and work more efficiently, not just at the Recreation Ground but across the whole village, as maintenance and support for parish-owned spaces continues to increase.

Having appropriate facilities in place supports health and safety, improves organisation, and frees up other spaces, including the Pavilion, to be used more flexibly for community activity rather than operational storage.

Residents are encouraged to view the application and submit comments through the planning portal. These comments will be considered as part of the planning process.

See Planning Application here: <https://shorturl.at/uxWmf>

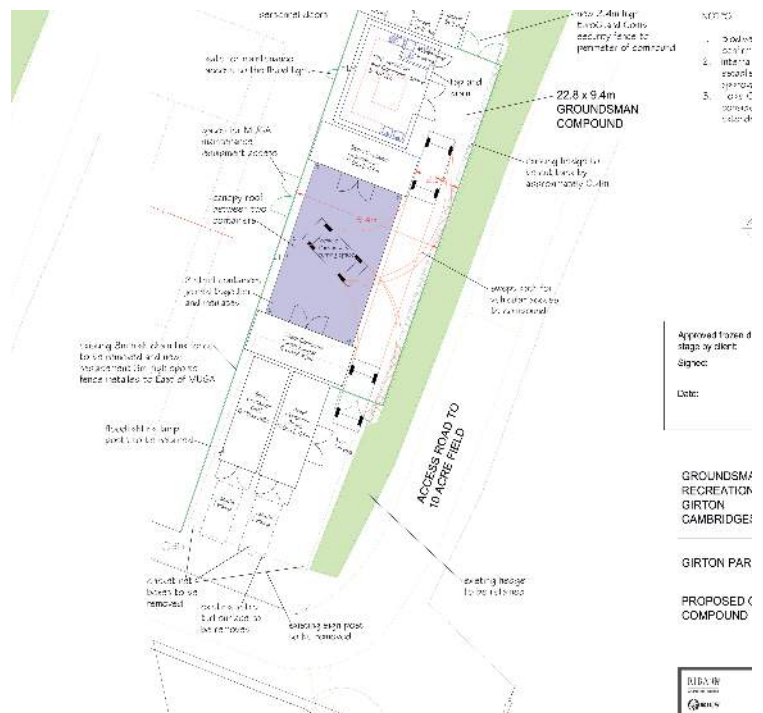

**Weavers Field, play inspections and early engagement**

Thank you to residents at Weavers Field who have taken time to come together to engage constructively on the future of the play area. Annual play inspections and health and safety requirements are a key driver for this work, both at Weavers Field and for the Trim Trail at the Recreation Ground.

The council has a responsibility to make sometimes difficult decisions to ensure equipment is fit for purpose and safe to use. Early engagement helps ensure that options are shaped with residents’ priorities in mind before specifications or quotations are finalised.

At this stage, the council is still thinking through options. We do not need to have all the answers yet. What matters is that health and safety, cost, longevity and community input are all considered before decisions are made.

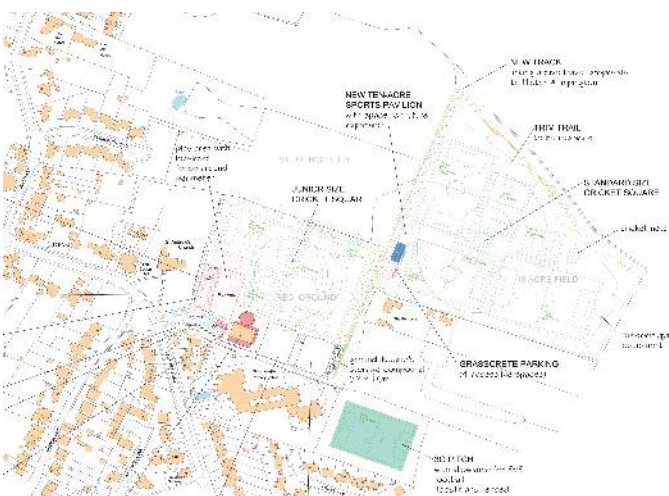

Indicative layout showing the Recreation Ground and Ten Acre Field, which form the focus of current cricket and facilities planning.



Weavers Field play equipment

### A new Parish Council from May

The new Parish Council term will begin on 7 May 2026. The recent parish election was uncontested, and the council will start the new term with four vacancies. This affects councillor capacity rather than the council's responsibilities or legitimacy. District Council elections will also take place on 7 May 2026, and residents are encouraged to take part.

A strategy meeting has been approved for the incoming Parish Council. This will provide space to reflect on priorities, ways of working and how to build on the foundations already in place. We would like to thank councillors who are stepping down for their service over the last four years: Daniel Carney, Patrick Linton and Archie Bajpai and all others who have served Girton during this term.

We also thank those councillors who will be serving in the new council and welcome their commitment to representing the village.

### Annual Parish Meeting and Annual Council Meeting

Residents are warmly invited to two important upcoming meetings:

#### Annual Council Meeting – Wednesday 13 May 2026

This is where the new Parish Council formally appoints roles and agrees governance arrangements for the year ahead. Further details will be shared on the Parish Council website, village noticeboards and the Girton Village Community Facebook page.

#### Annual Parish Meeting – Friday 22 May 2026

This is a meeting of the parish, not just the council. It will give insight into what will be happening over the next four years and provide information on decisions made this year, including the precept. We hope to include speakers to give insight into some of our key priorities.

Yvonne Murray  
Parish Council Clerk  
clerk@girton-pc.gov.uk

### Puzzle solution (see page 23)

1	R	E	Q	L	F	O	C	V	U	Z	T	N	P
14	D	H	I	K	G	S	Y	A	X	W	M	B	J

## Girton Glebe



On Tuesday 24 February, our Girton Glebe School Choir travelled to the O2 in London to take part in Young Voices, one of the largest children's choir concerts in the world. What an unforgettable experience it was!

Led by Mrs Knowler and accompanied by Miss Roddy, Mr Warren, Mrs Bates and Mrs O'Donovan, our 50 choir members represented the school brilliantly from start to finish. The staff team did an outstanding job supporting the children throughout what was a very long and eventful day, including managing hungry tummies, a touch of travel sickness, and even a coach delay! Nothing, however, dampened the excitement.



Performing alongside thousands of other young singers in such an iconic arena is truly extraordinary. The atmosphere was electric as the children performed Golden from K Pop Demon Hunters, which was an absolute hit, as well as the rousing Wellerman by The Longest Johns and the wonderfully dramatic What Is This Feeling? from Wicked.

The sound of thousands of children singing together is something quite special and more than a little spine tingling! For many of our pupils, it was their first time inside an arena, let alone performing in one. They sang with confidence, enthusiasm and huge smiles throughout. It was a bonding experience for children and teachers alike, filled with joy, laughter and a great deal of shared pride.



We are incredibly proud of every single member of the choir. Despite the long day and the inevitable travel adventures, it was all worth it. We are already counting down to the next one. Young Voices 2028, we will see you there!

Chris Butler, Headteacher



**HAYDN and BRAHMS**  
with CAMBRIDGE CHAMBER COLLECTIVE

**Music by Haydn & Brahms**

Sunday 10 May 2026 at 2:00pm • St Andrew's Church, Girton

Admission £12 in advance / £15 at the door • Carers & under-18s free!

<https://tinyurl.com/mrjremux>



**Cambridge Fullah Life Care Ltd. – Reg. No. 10808940**

Provides high-quality **Domiciliary** and **Live-in** home care services. We are Care Quality Commission (CQC) registered and regulated local family company, small enough to be personal.

**Our Services**

- Support with daily living activities, personal care, companionship, medication, etc.
- Live-In Care – Round-the-clock support in your home, including palliative & end-of-life care.
- Alzheimer's, asthma, diabetes, cancer, catheter, continence, dementia, mobility, Parkinson's, stoma, stroke
- Hospital discharge and convalescence & Respite Care
- Assistance with pets

We are so confident in our service that we offer a **free consultation** and a **free trial** with one of our professional caregivers.

*If we fail to meet your needs, just end the free trial.  
No questions asked!*

We are local with emphasis on employing local staff and we are currently recruiting for Girton and the surrounding areas.

T: Henry 07881591132 or Hassan 07990390399

E: [info@cambridgefullahlifecare.co.uk](mailto:info@cambridgefullahlifecare.co.uk)

W: <https://www.cambridgefullahlifecare.co.uk/>

Careers/jobs – email: [info@cambridgefullahlifecare.co.uk](mailto:info@cambridgefullahlifecare.co.uk)



**HATTONS**  
FENCE POST REPAIR

**ROTTEN, LEANING  
BROKEN FENCE  
POSTS FIXED**

**Fixed Price.**

**Fully Inclusive of Materials & Labour**

Email: [hello@hattonspostrepair.co.uk](mailto:hello@hattonspostrepair.co.uk)

Telephone or Text 07724 115 263

Visit [www.hattonspostrepair.co.uk](http://www.hattonspostrepair.co.uk)

**GIRTON  
JEWELLERY FAIR**

**Sunday 17<sup>th</sup> May 2026**

William Collyn Community Centre  
Wellbrook Way  
GIRTON  
Cambridge  
CB3 0GP

10 am – 4 pm  
Refreshments  
£2 Admission  
Free parking

Discover and purchase beautiful contemporary fine jewellery handcrafted by local talented designer makers at this Jewellery Exhibition, also includes vintage and antique jewellery.

[www.ruralmagpie.co.uk](http://www.ruralmagpie.co.uk)  
07803 052918

**MOBILE HAIRDRESSER**

ALL ASPECTS OF HAIRDRESSING DONE IN  
THE COMFORT OF YOUR OWN HOME



**CONTACT TANYA ON  
MOBILE: 07719 902450**

**STEAMROLLER IRONING SERVICE**

Free collection & Delivery



24/48 hour turnaround

Price 1lb in weight = £2.50 (minimum £30)

Please call me on 07742 319631 or  
01954 210672.

# From Our Councillors

## District & Country Councillor's report

### The District Council Election 7 May

To vote in this election, residents must be on the electoral register. The deadline to register to vote in these elections is 11:59pm on Monday 20 April. South Cambridgeshire District Council's elections team is encouraging residents who have not registered at their current address to make sure they are registered in time.

Anyone can apply online at: <http://www.gov.uk/register-to-vote> and it takes just five minutes to do so. Residents who are not registered by the end of the day on Monday 20 April will not be able to vote. If you were eligible to vote in last year's elections, and your details have not changed – it is very likely you will still be registered. If you are not sure whether you are registered, check your details with South Cambridgeshire District Council's Elections team by emailing: [elections@scambs.gov.uk](mailto:elections@scambs.gov.uk)

If you want to apply for a postal vote, you must do this by 5pm on Tuesday 21 April. Due to recent changes in the law, postal votes now expire after three years. The district council recently wrote to a number of affected residents to tell them their postal vote had been removed due to this change. Those residents will also need to make a new application if they want to reinstate their postal vote. If you want to apply for a proxy vote, the deadline to do that is 5pm on Tuesday 28 April.

As is now normal process for local elections in England, voters will need to show an accepted form of photo ID at their polling station. If you do not have a photo ID that allows you to vote, you can apply for a Voter Authority Certificate for free. This is a paper document with your photo on it that you can use to prove your identity when voting. The deadline to apply for a Voter Authority Certificate is 5pm on Tuesday 28 April.

### New study unveils the vital role of local markets across Greater Cambridge

New independent research has highlighted the vital role markets play in community life and details steps to help them thrive in Greater Cambridge.

Cambridge City and South Cambridgeshire District Councils jointly commissioned the "Greater Cambridge Market Economic and Social Impact Assessment," which sets out how traditional retail markets contribute to the area's economy, strengthen communities and enrich local culture.

The assessment highlights the vital contribution of the three Cambridge and seventeen South Cambridgeshire markets and sets a roadmap for their future growth and sustainability.

The report reflects extensive engagement with traders, residents, market shoppers, community organisations, and local businesses, and demonstrates that traditional markets across the region not only support employment and apprenticeship opportunities, but also enrich local character, strengthen community interaction, and give people access to diverse products - including produce that might otherwise be unavailable locally.

### Fly Tipping

We had three fly tipping incidents in a week. To report fly tipping, click on the South Cambridgeshire District Council website, the menu has "Reporting fly tipping." The reporting process will ask what the fly tipping consists of. A photo helps. The team will check to see if any of the rubbish has an address amongst the rubbish so they can fine the people responsible. They also want to know about any vehicles you see tipping out rubbish. It took about a week for these piles of rubbish to be removed.

### Potholes

This problem is nationwide and is particularly bad this year. Thank you to all residents who report them on the county's reporting system – this really does help. The tool is on Cambridgeshire County Council Website under "Reporting a Highway fault." A photo helps too. Reporting on the system means the pothole will be investigated and if they fit the criteria for filling, they are circled by yellow spray paint, and the work will be done. We also have post work inspections to ensure that the work done is of good quality, and we get the contractors to re-do it if not.

The county council has invested an additional £20m per year for last year and this year – adding to the highways maintenance budget which councils receive from government. This enables us to bring extra effort to the problem when it is at its peak but also to do preventive work – fixing potholes before they emerge. It is a massive problem, but it has come about through years of underfunding but also large numbers of HGVs bearing down on roads of deteriorating condition. Properly reconstructing roads – the ultimate solution for our 'end of life' roads – costs £800k/km. We have approximately 4000km of roads in the county and a total highways budget of £58m pa so this is not an option for us except in truly exceptional cases.

### Holiday food vouchers for children with free school meals

The government has stopped a major programme (Housing Support Fund) which the county council used to fund a scheme to provide holiday food vouchers to families where children had free school meals. We felt it was important not to have hard pressed families, many of whom relied on the holiday food vouchers, to experience a 'cliff edge' when the funding was withdrawn at the end of March this year. Therefore, we have exceptionally found £2.7m in the budget to continue funding vouchers in the holidays up to September. At this point a new scheme of support for people experiencing financial difficulties will be up and running and we will provide more information nearer the time on how help can be accessed.

### District Councillors:

Cllr Corinne Garvie (07780 932267)  
[cllr.garvie@scambs.gov.uk](mailto:cllr.garvie@scambs.gov.uk)

Cllr Richard Stobart (07950 934793)  
[cllr.stobart@scambs.gov.uk](mailto:cllr.stobart@scambs.gov.uk)

### County Councillor:

Edna Murphy  
[Edna.murphy@cambridgeshire.gov.uk](mailto:Edna.murphy@cambridgeshire.gov.uk)



# MORE THAN JUST A GOLF CLUB

## MEMBERSHIP OPTIONS FROM £475.00

- 5-7 Day Full
- Flexible
- Intermediate
- Junior
- Social

## COACHING

- Driving Range
- Putting Green/Chipping Area
- Swing Studio
- PGA Professional Coaching
- Group/Individual Lessons



## VISITORS WELCOME

Come along and try the course – either book online or phone Golf Reception

## FUNCTION FACILITIES

We have superb Clubhouse facilities available for private hire:-



- Weddings
- Birthdays
- Anniversaries
- Funeral Receptions
- Business Meetings
- Presentations



All supported by our in-house Bar and Catering staff

## CONTACT US NOW

Phone Golf Reception on 01223 276169

office@girtongolf.co.uk      www.girtongolf.co.uk

Dodford Lane, Girton, Cambridge, CB3 0QE

# FORTHCOMING EVENTS

## MUSIC AT GIRTON COLLEGE – MAY 2026

### Compositions in Tonal Styles

Sunday 3 May, at 2.00pm – NB: time – (until 3.00pm), Old Hall, Girton College. A selection of works written by Girton students for the 2026 Music Tripos examinations, including pieces in the styles of Bach, Mendelssohn, and Elgar. Admission free; retiring collection.

### From Near and Far: A Musical Journey with Piano(s)

Sunday 10 May, at 2.30pm (until 3.30pm), Old Hall, Girton College. Charlotte Howdle and Sophie Kileff (violins); Elizabeth Ip (viola); Archie Purdue (cello) with Oscar Gardner, Rufus Jasko, Tomás Escobar, Archie Purdue, Morvern Scrivener, Amanda Zhou, and Martin Ennis (piano)

In this wide-ranging programme, we hear movements from Dvorak's ever-popular Piano Quintet, alongside Milhaud's exhilarating *Scaramouche* for two pianos, originally written for a 1937 international exhibition and built round South American popular music, and Colin McPhee's dazzling transcriptions for two pianos of Balinese ceremonial music. Admission free; retiring collection.

### Girton Jazz presents Alex Garnett

Friday 15 May, at 7.30pm (until 9.30pm), Old Hall, Girton College. Saxophone sensation Alex Garnett appears alongside James Pearson (piano), Conor Chaplin (bass), Luke Tomlinson (drums), and Tim Boniface (saxophone). Tickets from: [www.girton.cam.ac.uk/girton-jazz](http://www.girton.cam.ac.uk/girton-jazz); early booking advised.

### Recital Programmes

Sunday 17 May, at 2.00pm – NB: time – (until 3.30pm), Old Hall, Girton College. Greg Burford (baritone; with Edward Campbell-Rowntree, piano). Myriam Lowe (voice; with Xavier Lowe, viola da gamba, and Danny Murphy, theorbo), Morvern Scrivener (piano)

Three of Girton's Music students perform their final-year recital programmes; repertoire to include works by Dowland, Purcell, Schumann, Janáček, Menotti and Barber. Admission free; retiring collection.

### Sonatas for Violin and Piano

Sunday 24 May, at 2.30pm (until 3.30pm), Old Hall, Girton College. Sharon Liang (violin) and Samuel O'Neal (piano).

Alumnus Samuel O'Neal, well-known to GCMS regulars, returns to Girton with his regular duo partner to perform Brahms's D minor Sonata, Op. 108, and Poulenc's Violin Sonata, alongside Ponce's 'Estrellita' and works for solo piano. Admission free; retiring collection.

### Prize-Winning Pianist returns to Girton

Sunday 31 May, at 2.30pm (until 3.30pm), Old Hall, Girton College.

Finnish concert pianist Julia Wallin presents a recital that combines virtuoso repertoire by Liszt and Rachmaninov with rare gems by Finnish composers Melartin, Hannikainen and Kuula; the programme explores unexpected connections between these composers and their music. Admission free; retiring collection



Sunday 14th June 2026  
**Open Gardens**  
 Would you like to open your garden this summer?  
 Entry is FREE  
 Please email us at: [girtonopengardens@gmail.com](mailto:girtonopengardens@gmail.com)  
 10 to 1pm Girton College end of village  
 2 to 5pm Church end of village  
 Collect an information sheet of all the open gardens on the day from  
 72 Girton Road  
 49 Cambridge Road  
 St John's Farmhouse 80 High Street  
 Refreshments will be available at some gardens



**Girton Musical Theatre**  
**Heroes and Villains**  
 A Summer Concert of music, poetry and prose  
 Friday 26<sup>th</sup> June, 7.30pm  
 St Andrew's Church, Girton  
 Tickets £7 (£3 children)  
[www.ticketsource.co.uk/girtonmusicaltheatre](http://www.ticketsource.co.uk/girtonmusicaltheatre)  
 (or on the door)  
 Refreshments available



**TURTLE DOVE** CAMBRIDGE  
**GIRTON POP UP CAFE EVERY FRIDAY**  
 TEA, COFFEE, CAKES AND BITES  
 OPENS FROM 11:30 AM TO 4:00 PM COTTON HALL GIRTON  
 Join us at the Turtle Dove Pop Up Cafe at Cotton Hall, as we bring our delicious food and warm, welcoming service to Girton every Friday!  
 Who are Turtle Doves?  
 Turtle Dove Cambridge is a social enterprise supporting young women aged 14-24 into the workplace through meaningful training and real life work experience. Our pop-up cafes and catering events give them the chance to grow in confidence, gain skills, and connect with the community.  
 Come and try our selection of freshly made cakes, light lunches, and great coffee – all served with a smile. Every bite supports a brighter future.  
 Everyone welcome – come say hello!



**Girton Garden Society**  
 Wednesday 13 May 2026, 7.30pm.  
 At William Collyn Community Centre, 'Managing a college garden for sustainability, biodiversity and wellbeing' by Keith Jordan, Gardener, Murray Edwards College.  
 A brief introduction to changes in the college garden with an emphasis on sustainability, biodiversity, and wellbeing. Followed by a Q&A with pre-prepared members' questions.  
 Visitors and new members are always very welcome (£2 per session).  
[www.girtongardensociety.co.uk](http://www.girtongardensociety.co.uk),  
[girtongardensociety@outlook.com](mailto:girtongardensociety@outlook.com)



# PS Dean Roofing

**Traditional Roofing Contractors**

Slates, Tiles, Guttering, Chimney's and Re-pointing  
Re-roofing, Repairs, Lead-work, Free Quotations

**01223 572504 07752 711175**

[paul@psdeanroofing.co.uk](mailto:paul@psdeanroofing.co.uk) [www.psdeanroofing.co.uk](http://www.psdeanroofing.co.uk)

22 Longstanton Road, Oakington, Cambs, CB24 3BB

**Leaf and Lawn**  
FENCING WITHOUT BOUNDARIES

Making your outdoor spaces beautiful – and secure

FENCING | CLEARANCE | LANDSCAPING

**0800 206 1585**  
[leafandlawn.co.uk](http://leafandlawn.co.uk)

**Which?** Trusted Trader RATED 5/5

*Martin* **Nelson** *Motors*  
of Girton

Doctors, Dentist, Shops Official Girton Charity Hospital Trips

**The local Taxi Service**

**Tel: 01223 276654**

Local trips, Airports and any Long distance door to door service

Using modern 100% fully Electric vehicles

**Perfect Condition**  
Multisport Coaching Consultants

**-1 TO 1 SWIM COACHING-**

Improve your understanding, technique, performance and enjoyment.

All abilities. All ages.

I have my own coaching pool right here-in Girton

[www.PerfectCondition.co.uk](http://www.PerfectCondition.co.uk)

**Paul Waldmann Woodwork**  
Established 1982

Furniture made & restored  
Cupboards & bookcases  
Garden furniture & fittings

Basic woodwork sessions for young people & adults, see website for more details

phone for a FREE ESTIMATE 01223 314001  
41 Norfolk Street, Cambridge CB1 2LD  
Email [paulwaldmann169@gmail.com](mailto:paulwaldmann169@gmail.com)  
[www.paulwaldmanndesign.co.uk](http://www.paulwaldmanndesign.co.uk)

**ARE YOUR LOCKS BEHAVING BADLY?**

A Local Trusted Family Business Since 1989

**Christopher LOCKSMITH**

Specialist in UPVC & Wooden Doors

No Call Out Charge All Work Fully Guaranteed

No Fix No Fee 10% Senior Citizen Discount

For More Advice & Help Call Christopher: **07772 111 222**

[www.christopherthelocksmith.co.uk](http://www.christopherthelocksmith.co.uk)

**OAP Skips - cheap skip hire!**

Based in Dry Drayton but we cover:  
Bedfordshire, Cambridgeshire & Hertfordshire.

Quick turnaround.

One size skip only - 4 yard.  
£150 per skip

Call Gary today on 07706 032544!

We're delighted to be contributing to the May edition of the Girton Parish newsletter! We have to start by sharing some fantastic news from Gretton School...



We can now reveal that we underwent a two-day Ofsted inspection from 10th–12th February for our boarding provision and have been rated Outstanding for the fifth consecutive year!

Ofsted rated the school outstanding in all three areas it assessed, which were: overall experiences and progress of children and young people; how well children and young people are helped and protected; and the effectiveness of leaders and managers.

While we are extremely proud of this achievement, we are even prouder of our learners, who sit at the heart of our provision. Their progress, resilience, and the remarkable potential they continue to demonstrate every day are the reason we do what we do.

If there's one word that captures this observation, it's "opportunity." It's the thread that runs through everything we do at Gretton - from everyday learning and nurturing relationships, to the adventures and experiences that help our learners grow in confidence and independence.

This year has already seen some amazing trips, and even more are happening as you read this! Our Year 6 and 7 learners set off first for their one night residential last month, quickly followed by our Year 8 and 9 group for their two night trip. Across both trips, our learners were absolutely fantastic.



Throughout the trips, learners threw themselves into a wide range of adventurous activities including paddle boarding, rifle shooting, axe throwing, and raft building. Evenings were spent around the campfire, toasting marshmallows, singing together and sharing plenty of laughter. These are moments that truly captured the spirit of the experience. We are incredibly proud of every learner and grateful to the dedicated staff who made these memorable experiences possible.



It was wonderful to see our learners step outside their comfort zones, supporting one another and celebrating achievements. From braving chilly water and mastering paddle boards to building rafts and perfecting their aim, their resilience, teamwork, and positivity were exceptional.

This week, our Rectory learners are soaring to new heights, quite literally! They've jetted off to Barcelona for a residential adventure, and we'll be sharing all their amazing stories and discoveries in our next newsletter contribution.



Back at Gretton, our learners have been busy learning, creating, and celebrating! We marked Red Nose Day with a Pizza & Pastry event, raising funds for Comic Relief while enjoying (and taking home!) a delicious range of pizzas and pastries, from sausage rolls and pies to croissants and danishes.

We also celebrated World Book Day with a stop-and-read moment across the school. Learners and staff dressed up as their favourite book characters, bringing stories to life. One primary class dived into the world of Willy Wonka, designing their own chocolate bars in Food Technology, while other classes enjoyed their weekly library sessions with Skylar, one of our mentor dogs, fostering a love of reading in a calm and engaging environment.

Once our learners return from their Easter holidays, it'll be full steam ahead! Exams will begin, Duke of Edinburgh adventures will be underway, and we'll be celebrating some of our favourite summer events, including our annual Pride Event! We can't wait to share all the excitement and achievements with you in the months ahead.



## Scouts & Cubs brave cold to raise vital funds for homeless ex-servicemen and women

On 28 March, the 10th Cambridge (Girton) Scouts and Cubs took on The Great Tommy Sleep Out on the Girton Glebe sports field.



We spent the night outdoors to raise funds for the Royal British Veterans Enterprise (RBVE) and to shine a light on the challenges faced by homeless ex-servicemen and women. The RBVE set the Sleep Out challenge for March to help people experience, in a small way, the harsh conditions that many veterans have to endure. And believe me... it was cold. On Sunday morning, we all found ourselves scraping ice off the tents!

Despite the freezing temperatures, the 10th Scout Group smashed it and raised £170 for the veterans. We're incredibly grateful to everyone who supported us and helped us exceed our target.

A huge thank you as well to Girton Glebe for letting us use the field for our camp - it was absolutely brilliant.

*The leaders of the Scouts, Cubs and Beavers of the 10th Cambridge (Girton) Scouts Group*

**fen** mobility centre 

Scooters      Wheelchairs      Beds  
 Recliners      Walking Aids      Living Aids  
 Stairlifts      Ramps      Personal Care

**Expert Advice | Sales | Service | Repair**  
**Occupational Therapy**

- ✓ Over 30 Years of Mobility Experience
- ✓ 100's of Items in Stock for Same Day Collection or Delivery
- ✓ Occupational Therapist on Site
- ✓ Test Drives & More
- ✓ Zero Pressure Guarantee
- ✓ Assessments in our Centre or Your Home
- ✓ Outstanding Aftercare, Warranties, Repair, Service & Hire

01353 653 753      www.fenmobility.com  
 Unit 5c Lancaster Way Business Park  
 Ely CB6 3NW

**Rebecca Orde**

**Managing Your Property Renovations**

I help clients in Cambridge and surrounding areas renovate their homes. I will guide you through the whole process from concept to completion, taking away all the stress that comes with undertaking a building project.

- ✓ A single point of contact
- ✓ A network of trusted trades
- ✓ Keeping your project on time & on budget

*"It became very evident very quickly that using a professional project manager was a wise and sensible investment."*  
 - Phillip W.

**Phone: 01223 782125**  
**Email: info@rebeccaorde.com**  
**Website: www.rebeccaorde.com**

**MMWealth**  
 Chartered Financial Planners

**Is it time you had a full review of your financial needs and objectives?**

With the government having made **significant changes** over the last couple of **Autumn Budgets**, it is very likely your current financial planning strategy requires a full holistic review to ensure it continues to meet your financial needs and objectives.

Whether it's passing money to loved ones and the **impact of the pension changes** or **Agricultural Property Relief to Inheritance Tax**, the increase in **Capital Gains Tax** or you're a **business owner** affected by the Budget, we can help evaluate your unique situation to ensure your future needs continue to be met.

With an experienced and well qualified team, **MM Wealth offers** a wide range of **holistic services**, including estate planning, use of trusts, pension advice including use of SSAS and SIPPs, Discretionary Portfolio Management and protection planning. We are **committed** to working with **our clients, their families** and alongside your accountants and solicitors to create financial plans **through all life's stages**.

**If you would like to talk to one of our Chartered Financial Planners, please contact us on 01223 233331 or email [info@mmwealth.co.uk](mailto:info@mmwealth.co.uk) for advice.**

Wellbrook Court  
 Girton  
 Cambridge  
 CB3 0NA  
 t 01223 233331  
 w [mmwealth.co.uk](http://mmwealth.co.uk)





**Disclaimer**  
 Opinions constitute our judgment as of this date and are subject to change without warning. The value of investments and the income from them can go down as well as up, and you may not recover the amount of your original investment. The information in this article does not constitute a personal recommendation. The Financial Conduct Authority does not regulate estate planning and tax planning.

**MM Wealth Ltd is authorised and regulated by the Financial Conduct Authority. Incorporated in England and Wales. Registered number 01454074**

## Wild Girton

### Operation Turtle Dove

Had you walked along the lanes and fields of Girton in late May and June during the 1960s and early 70s, chances are you'd have heard a purring sound coming from any dense hedgerows or scrub in the village.

The bird making these sounds would have been a Turtle Dove, Britain's only migratory dove. The Turtle Dove is a small member of the pigeon family – about a third the size of our familiar Wood Pigeon with chestnut and black spotted wings, a bold black and white neck patch, pinkish breast, and a distinctive white tail tip.



### Decline

Turtle Doves were until recently the UK's fastest declining bird species, having faced a population crash since the 1970s of around 99%. The reason for their decline is twofold: a loss of suitable breeding habitat, compounded

by unsustainable hunting pressure on their migration routes through Southern Europe in the 90s.

### Recovery?

The good news is that we can turn this around. A change in EU hunting management policy that led to a four year pause from 2021 has led to a bounce back in numbers in Western Europe. Moreover, research by the Royal Society for the Protection of Birds (RSPB) and others has identified the conditions that Turtle Doves require to recover and thrive here in the UK. This is being put into practice through Operation Turtle Dove, a collaborative project led by the RSPB, in partnership with Pensthorpe Conservation Trust and Natural England.

### What do Turtle Doves need?

At its simplest, the same as most birds – food, nesting habitat, and water. However, Turtle Doves are limited by needing to access the small seeds they rely on for their diet. They require sparse vegetation with patches of open ground to be able to find seeds. Ironically one of the best habits for them can be rough farm tracks.



To nest they require dense thorny scrub and wide hedgerows. And, because their diet is so seed-rich, accessible water (such as shallow sided ponds).

### What is Operation Turtle Dove doing?

The project works with farmers and landowners on habitat restoration or creation for Turtle Doves. Advisors identify suitable sites that could be 'Turtle Dove Ready.' These are sites where the species is already present or, in many cases, sites with the potential to host Turtle Doves in the future.

Within the site, farmers and landowners are advised on how to improve their spaces for Turtle Doves – in some cases cultivating land to allow the right plants to grow; in others planting a

wildflower seed mix. On some sites, providing supplementary feeding with a seed mix can help adult birds early in the season when the plants they need are not in bloom. Advisors also help farmers and landowners evaluate water resources and offer management advice for nesting habitats.

Monitoring is a key part of the work, and a member of the Wild Girton team has been working with volunteers deploying trail cameras on suitable sites in Cambridgeshire to record any Turtle Doves that may be present. It is early days, but the signs are good.

### Turtle Doves in Girton?

Turtle Doves do not breed in Girton (yet!), but we are close to an area where they are known to be present. We may, with a fair wind be able to tempt them back. There are two sites in the village on private land that have the potential to host them, and the RSPB is working with one of the site managers to see if we can encourage them to return.

If you see or hear a Turtle Dove, it is important to submit a record. Send details of date, time, location and if possible brief details of what the bird was doing (e.g. singing, feeding, drinking, carrying nesting material) to either the British Trust for Ornithology (BTO) via BirdTrack <https://tinyurl.com/5n6as47e>, or to us at [lnrp@girton-pc.gov.uk](mailto:lnrp@girton-pc.gov.uk), or message the Wild Girton team on Facebook or Instagram.

And if you want to know more about Operation Turtle Dove, you'll find details at <https://www.operationturtledove.org/Girton-Local-Nature-Recovery-Plan-Group>

(Photos copyright of Ben Andrews, RSPB images)

## Eddington Beer Garden 2026



Now in its fourth year, the Eddington Beer Garden is back - a firm community favourite that takes over Eddington Square for a weekend of live music, good food and great company.

Enjoy craft beverages and cask ales from local breweries, alongside exquisite gins and prosecco, with low-and-no alcohol options also available. A lively line-up of local live music runs across all three days, with highlights including a special teaser act for the Cambridge Folk Festival. A variety of street food trucks will be on site each day, covering everything from BBQ and Korean street food to vegan wraps and sweet treats.

Opening times: Friday 8 May: 4pm – 10pm Saturday 9 May: Noon – 10pm Sunday 10 May: Noon – 6pm

Entry is free, but advance registration is requested. Tickets and further information at:

<https://bit.ly/beer garden2026GN>

# JASON KIRBY LTD

EXPERT DECORATORS

All Aspects of Internal & External Decorating  
 Period, Residential & Commercial Properties  
 Wallpaper & Mural Install  
 Kitchen Cabinet & Furniture Re-Sprays  
 Floor Sanding & Restoration  
 Plastering, Coving & Artex  
 City & Guilds, NVQ Qualified  
 For Service, Quality & Reliability



 **01954 211775**  
 [jasonkirbyltd.co.uk](http://jasonkirbyltd.co.uk)





300007

The Complete Gas Heating and Plumbing Company

**Plumbing • Heating • Gas  
 Bathrooms • Water Softeners  
 Property Maintenance**

**Tel: 01954 204044 • Web: [www.entiregroup.co.uk](http://www.entiregroup.co.uk)  
 Email: [service@entiregroup.co.uk](mailto:service@entiregroup.co.uk)**

## P. LOVERIDGE

*Carpentry & Locksmith Services*

**TEL: 01954 202907 MOB: 07811 158018  
 EMAIL: [PAULLOVERIDGE31@GMAIL.COM](mailto:PAULLOVERIDGE31@GMAIL.COM)**

ALL ASPECTS UNDERTAKEN

FITTED WARDROBES ALCOVE CUPBOARDS KITCHENS FITTED FIRST & SECOND FIX	LOCKS REPAIRED & REPLACED EMERGENCY ACCESS LOCKS KEyed ALIKE HOME SECURITY UPGRADED
---	--

### K & S Services

All Aspects of Carpentry & Joinery  
 Internal/External Painting & Decorating  
 Wall & Floor Tiling    Laminate & Wood Flooring  
 Kitchen Fitting        Bathroom Refits  
 Fencing                 Heating Systems

84 Pheasant Rise, Bar Hill, Cambridge CB23 8SB

**Tel: 01954 200869 Mobile: 07548 796094**

The Complete Bespoke  
 Picture Framing &  
 Printing Service



**Oakington, Cambridge**

**01223 439001**  
**[info@hmcframing.co.uk](mailto:info@hmcframing.co.uk)**

 Open Monday-Saturday  
 Collection & Delivery Available  
[hmcframing.co.uk](http://hmcframing.co.uk)

- FRAMING
- MOUNTING
- CLEANING
- REPAIRS

# DS ELECTRICAL

Professional Domestic & Commercial Electricians

**Mob: 07870 372788**

[www.ds-electricalservice.co.uk](http://www.ds-electricalservice.co.uk)

# COULSON

Plumbing ♦ Heating ♦ Electrical

**01223 423750**  
**[services@coulson.co.uk](mailto:services@coulson.co.uk)**



**All aspects of plumbing, heating and electrical works undertaken. From small maintenance tasks to large scale replacement & upgrade works.**

Plumbing: Bathroom Refurbishments; Hot Water Cylinders.  
 Heating: Gas Boiler Servicing; Boiler Replacements & Upgrades; Central Heating Installations; Boiler Breakdowns & Faults.  
 Electrical: Electric Vehicle Charging Points; Consumer Unit Upgrades; Electrical Installation Condition Reports.

Delivering excellence since 1884







## W J Guttering & Drainage

NO CALL OUT CHARGE - FREE QUOTATIONS



**Gutter Cleaning, Repairs,  
 Replacement,  
 Soakaways & Blocked Drains**

**01223 510623**  
**Mobile: 07720 146815**

---

# GIRTON

---

# scoreboard

---



## Girton Bowls Club

With the changing of the clocks and the sporadic improvement in the weather, we can begin to look forward to the opening of the outdoor bowls season.

Considerable maintenance work has been carried out in order to get the green ready. This has included top dressing, the application of fertiliser and grass seed, and it has been scarified and cut. Well done to all our volunteer maintenance team for all their hard work. A work party was then organised to carry out finishing touches like laying down all the rubber mats that go in the gulleys surrounding the green, varnishing the benches and setting out the flower tubs.

Girtons' Indoor/Outdoor teams have had another very successful season indoors. Girton 1 played twelve matches this season in Division 1, winning nine and losing three. They finished second in the League, just six points behind the winners, Cambs & County.

Girton 2 played fourteen matches in Division 3, winning nine and losing five, also finishing second in their League, one point ahead of Coleridge but some way behind Cottenham B. Depending on the entries, Girton 2 should be promoted to Division 2 next season. A suggestion was made that we enter three Indoor teams next season, which has been agreed.

The bowls green was officially opened from 16 April and our first event was a very successful Ladies v Gents competition followed by refreshments.

Our annual Open Triples competition will be held on 21 June and so far we have fourteen confirmed entries. The entrants for the external competitions have now been confirmed and entries for Club competitions are largely complete. The Cambridge and District finals will be held at Coton Bowls Club on 12 September and our internal Club finals will be held on 22 August.

We would like to thank all our generous Sponsors for their continued support for the coming season. They are: Peasgood and Skeates, Urban Cars, Sean's Newsagents, Redmayne Arnold and Harris, Arlington Manor, MM Wealth, Oakington Garden Centre and The Plough at Coton.

If you are interested in finding out about joining Girton Bowls Club, please see our website [www.girtonbowlsclub.weebly.com](http://www.girtonbowlsclub.weebly.com) or contact our Secretary, Margaret McCall, at [margaret.mccall@ntlworld.com](mailto:margaret.mccall@ntlworld.com). We are always pleased to welcome new members.

*Lynn McGill*

## Girton Tennis Club



Our membership year started at the beginning of April so court access codes and court booking passwords will have recently changed. All current members will have been informed.

If you are thinking of joining us, now is a very good time as your membership payment will cover you right up to the end of March 2027. We had over 200 members last year and, with such numbers, we are able to keep our fees at a very reasonable level. Although costs are increasing, our AGM agreed to keep membership fees frozen for another year.

Once a member of our club, you are entitled to register with the LTA via their website (no cost involved). This gives you an additional way of entering the Wimbledon ticket ballot and other benefits, such as early access to hear about and buy tickets for other tennis tournaments.

We have entered teams in the Men's, Ladies and Mixed LTA Summer Leagues for 2026. If you would like to take part in these friendly but competitive matches please get in touch via our website. If you do take part, we will need your LTA registration number to process match results.

The tennis club has use of the recreation ground courts and members who have a confirmed booking have court access during most daylight hours. The junior member supervised sessions started again on 17 April and, weather permitting, will run every Friday evening from 6.30pm to 7.30pm. Club members meet and play from around 7.30pm to 9pm. Potential new members are very welcome to come along to our Friday club nights for one or two free sessions to check it all out. With the weather improving, it would be lovely to see a few more of our members at Club night.

Details about our activities can be found on our website [www.girtontennisclub.uk](http://www.girtontennisclub.uk) or by contacting our Membership Secretary by email at [info@girtontennisclub.uk](mailto:info@girtontennisclub.uk).

*Alan Franklin*

# Girton Musical Theatre's Iolanthe (February 2026)

Extracts from Review by Phil Melia

Girton Musical Theatre's staging of Iolanthe, the beloved Gilbert and Sullivan operetta, proved to be a delightful evening brimming with charm, wit, and vibrant spectacle. This production deftly balanced the satirical interplay between fanciful fairies and British political intrigues, offering both laughter and thoughtful commentary. The company brought comedic timing, with well-executed moments eliciting genuine amusement from the audience. The visual elements were equally impressive: colourful costumes and imaginative scenery demonstrated a keen eye for detail and creativity.



Act One transported us to the fairies' enchanted kingdom, an idyllic backdrop adorned with wistful trees. Act Two raised the bar further, unveiling a

dramatic set transformation to the stately Houses of Parliament and London streets, immersing viewers in the political heart of the tale.

Costume design, courtesy of Maggie Phillips, was a triumph. The nine fairies appeared in a kaleidoscope of pastel, bridesmaid-like dresses complemented by delicate chiffon wings, while the male characters donned a range of attire from polished morning suits to sumptuous velvet Lords' gowns. The Grenadier Guard in his crisp uniform added a dash of authenticity. The finale's clever touch—characters suddenly sporting fairy wings—delivered a visually satisfying conclusion.

Music was provided by a small but very skilled orchestra under the direction of Harley Jones, blending strings, woodwind, brass, and percussion. The live accompaniment elevated the performance, with the orchestra generally delivering a solid backbone to the singers.



Director Helen Wilson deserves recognition, not only for her inventive set design but also for weaving comedic moments throughout. The "Nightmare Song" featured clever visual cues from the cast, holding illustrated signs to emphasise key lyrics, adding an extra layer to an already entertaining number. I also loved the scene where toy guns

were used to illustrate Phyllis's frustrations and the guns got bigger and bigger – a nice touch!

Overall, Girton Musical Theatre's Iolanthe was a fitting tribute to Gilbert and Sullivan, skilfully blending satire and spectacle.... Well done to all involved—I eagerly await the next offering!

© NODA CIO.

All rights reserved, Photos by Caille Peri

## Sports In The Square

On Saturday 16 May you can try a new sport at the latest monthly pop-up event in Eddington Square. Hosted by the University Sports Centre, this month you can try Netball! Bring your friends and neighbours or come solo – there's space for all. Free to attend. No booking required.

Find out more here: <https://shorturl.at/VkQ5v>

**Girton Glebe Primary School**

# Pool Open

GIRTON GLEBE SWIMMING POOL IS NOW OPEN.

WE'RE DELIGHTED TO WELCOME YOU TO THIS MUCH-LOVED COMMUNITY SWIMMING POOL.

WE ARE OPEN FOR PRIVATE POOL HIRE OPTIONS.

SCAN THE QR BELOW FOR MORE INFORMATION.

**elaactive**

SCAN ME

**Art of Clean** "The Care Your Floors and Furnishings Deserve."

Carpet, Upholstery, Rug Cleaning & Wood Floor Restoration

"Impressed that you got hose from the van down the back garden. More impressed that you cleaned stains out of a 12 year old carpet. Clearly a superior service. Thank you."

Mr Tim Recordon, Girton

**Call today 01223 081494**

Please quote Girton 1

## FEAST WEEK VILLAGE FETE

SATURDAY JULY 11<sup>th</sup> 2026 12 - 5pm

### CALLING ALL GARDENERS - COMPETITION TIME

The Girton Allotment Society and the Girton Garden Society will be organising a **mini fruit, flower and vegetable show** in the main marquee

The categories chosen for our part of the show represent the fruit, vegetables and flowers most likely to be ready in early July, weather permitting!

We would like to encourage all adults and children living in the village to show off their gardening and growing skills by entering **any or all of** the following competition categories:

Adults	Vegetable/fruit classes	flower classes
1v. 3 sticks of rhubarb		1f. 3 stems of one type of flower in a tall, colourless glass jar or vase
2v. 5 beans (Runner or French)		2f. A bunch of garden flowers in a clear jam jar ( no labels)
3v. 5 potatoes (any variety)		3f. A bunch of roses(no more than 7 stems) in a clear jam jar (no labels)
4v. 3 onions (any variety)		
5v. 3 different vegetables		
6v. A small plate of fruit		
Children Vegetable/fruit/flower classes		
7v. 3 different coloured vegetables		9v. An imaginative creature modelled from vegetables, fruit and/or flowers
8v. The funniest looking carrot		

**Rules.** All entries must be brought to the main marquee between 10 and 11.30am and a small entry card filled in.

- . The vegetables and fruit will be displayed on 22/23cm white paper plates.
- . Judging and awarding of rosettes will take place at 12noon.
- . The winners will be announced soon after judging has finished and entries can be collected later.

Contacts:

Girton Garden Society- Kay Green 01223 276819 / Girton Allotment Society- Patsy Smith 07503 282199

## Residents, GTC Trustees and staff say thank you to Patricia

### Girton residents gathered together to say farewell – and thank you – to Patricia Johnston, Age UK Cambridgeshire & Peterborough Older Residents' Co-ordinator who left her role at the end of March after 11 years.

To mark her significant contribution Girton Town Charity Trustees presented her with a red Camillia for her garden at her final Tuesday Connections meeting and organised a tea party for Patricia with GTC Trustees and staff at the Orchard Tea Rooms, Oakington Garden Centre.

#### Bringing people together

During her time as Older Residents' Co-ordinator Patricia has made a real difference, by bringing people together for a walk, for conversation, introducing fitness activities, on-chair kurling, coffee mornings and the very popular Tuesday Connections Group with speakers or activities that involved everyone.

Ann Bonnett, Chair of GTC which has supported the initiative said: "It has been a privilege to have Patricia in this unique role in our Village for 11 years during which time she has made such a positive contribution to our community. We are very fortunate to have had her gentle and caring presence for so long and we all wish her very well for the future.

"I particularly remember during Covid when Patricia walked with and talked to so many residents who may not otherwise have left their homes. At her request, GTC provided additional three-seat 'Passing Through and Settling' benches throughout the Village to assist those who needed just a short walk, somewhere to sit outdoors and time for a safe catch up with friends or family."

#### Support and thanks

Speaking at the tea party Patricia said: "I will greatly miss being part of life in Girton and am very grateful to the many people who have supported me in this role in many different ways. It is simply not possible to start to express my thanks to people individually, so please take this as a sincere, if impersonal, thank you from me.

"Going forward I am looking forward to having more



Patricia Johnston (left), Age UK Older Resident's Co-ordinator receives a red Camillia from GTC Chair, Ann Bonnett to mark her retirement after 11 years.



Patricia with just some of the many residents of Girton who she has supported in so many ways during her time in Girton.

time to spend catching up with my friends and family and I am sure that I will soon be looking for new adventures to get me out of bed on Tuesday and Wednesday mornings!"

Melanie Pittock CEO Age UK C&P added: "I have no doubt the Village will miss Patricia enormously. She has been such a significant part of the community for a long time and has made a real difference. Her absence will naturally feel strange for everyone."

#### Looking to the future

GTC Trustees are now actively looking at the best way forward to continue outreach support in the Girton community. It will take time to appoint a new person but in the meantime Pat Dickens from Club 55 very generously ran another successful quiz for the Tuesday Connections Group

on 14th April and William Collyn Centre Manager, Tom Lee will be running an event on 12th May. Everyone is welcome to come and enjoy this event and we will expect an update on progress with our future outreach scheme.

If you want to be kept in touch with GTC's plans, please register your interest by sending your name and email address or contact the office with your details. Also look out for updates in future issues of Girton Parish News.

GTC Office  
22 High Street  
Telephone: 01223 276008  
Email: [gtc@girtontowncharity.org.uk](mailto:gtc@girtontowncharity.org.uk)

Girton Town Charity exists for purposes which include the relief of need in Girton, either individually or collectively, or the support of any charitable purpose for the benefit of the inhabitants of Girton.

Enquiries on behalf of individuals or village organisations may be made in confidence and addressed to any of the Trustees below:

Ann Bonnett (Chair)	t: 276008
Rachel Allchorne	t: 276008
Marc Bermann	t: 277319
Colin Carr	t: 276312
Gill Cockley	t: 276703
Lynn Henderson	t: 276008
Andrew Muston	t: 07831 591809
Patsy Smith	t: 07503 282199

**GTC office:**

**22 High Street, Girton,  
Cambridge CB3 0PU.  
01223 276008**

**email: [gtc@girtontowncharity.org.uk](mailto:gtc@girtontowncharity.org.uk)  
[www.girtontowncharity.org.uk](http://www.girtontowncharity.org.uk)**

Girton Town Charity Registered Charity No: 1130272

## Tuesday Connections

**Tuesday 12 May 2026  
William Collyn Community Centre  
2.00 - 4.00pm**

**All welcome to enjoy an event  
organised by Tom Lee  
and to catch up with friends  
over a cup of tea and biscuits.**

# WILLIAM COLLYN 1521 COMMUNITY CENTRE

## Monday

6.30am - 7.15am	AJR Fitness (Bootcamp)
9.30am - 12.30pm	Tumble Tots (school term time)
1.30 - 2.30pm	Kurling for over 55's
5.45 - 9.00pm	Relationship Counselling
6.00 - 7.00pm	Pilates with Wendy Jane mixed ability

## Tuesday

6.30am - 7.15am	AJR Fitness (Bootcamp)
9.15 - 11.00am	Yoga with Julia Dale
10.30 - 11.30am	Strength & Balance
11.15am - 12.15pm	Yoga with Jess
2.00 - 4.00pm	Tuesday Connections (monthly)
1.00 - 4.00pm	Cinema Club 55 (as advertised)
6.00 - 7.00pm	Pilates with Wendy Jane
7.30 - 10.30pm	Easton Swing

## Wednesday

10.30am - 1.30pm	Falls Prevention Clinic
1.45 - 2.45pm	Pre-Ffit Strength & Conditioning
6.10 - 7.00pm	Bounce
7.30 - 10.00pm	The W.I. (1st in month)
7.30 - 10.00pm	Girton Garden Society (2nd in month)
7.30 - 9.30pm	Bookworms Book Club (4th in month)

## Thursday

6.30am - 7.15am	AJR Fitness (Bootcamp)
9.15 - 10.15am	Pilates with Wendy Jane intermediate
10.20 - 11.20am	Pilates with Wendy Jane beginners
2.15 - 3.45pm	Silver Swans ballet mixed ability
5.45 - 6.45pm	Pilates with Jax Eades
7.15 - 8.00pm	Ballroom Dance Class
8.15 - 9.00pm	Ballroom Dance Class

## Friday

10.00 - 11.00am	Crumb & Bass (under 5 years)
7.30 - 10.30pm	Easton Swing (3rd in month)

## Saturday

9.00 - 10.00am	Bounce
10.30am - 1.00pm	Cambridge Jazz Co-op
2.00 - 4.00pm	Farmers Market (2nd in month)

## Sunday

9.00 - 11.00am	Football Fun Factory (18mths - 5yrs)
----------------	--------------------------------------

Information correct at time of going to press.

## William Collyn Community Centre

Wellbrook Way, Girton, Cambridge

CB3 0GP

01223 279587

[info@williamcollyn.co.uk](mailto:info@williamcollyn.co.uk)

[www.williamcollyn.co.uk](http://www.williamcollyn.co.uk)

Owned and operated by Girton Town Charity



William Collyn  
Community Centre



@williamcollyncentre

**Rothwell's**  
Carpet Cleaning

01223 832 928  
www.Rothwells.biz

*A few points that make us stand out from the others,*

Rothwell's has been in business since 1993.

We're an honest local family firm.

Our large truck mounted machines mean more cleaning & drying power.

Members of both the NCCA and TACCA.

We will move the furniture for a thorough clean.  
100% satisfaction or it's FREE.

*Call Oliver and Max Campbell for expert help today.*



**Dust Free Wood Floor  
Sanding & Restoration**

Is your Wooden Floor in need of Sanding?

*"In one day our scratched and stained parquet floor was restored to its beauty of once long ago.*

*Many thanks." Mrs Baker, Impington*

Call today on **01223 081494**

*Please quote Girton 1*



**Prime  
Plumbing  
& Electrical**

For all your plumbing, electrical,  
heating and general maintenance needs  
Call Chris on

**07802 807237**

for immediate advice and free estimates



22a Cambridge Road, Impington,  
Cambridge CB24 9LR

Tel/Fax: 01223 237795

e-mail: primeplumbing@yahoo.co.uk

### Traditional Restorations

Quality Restorer for All Types of Furniture

Repairs, French Polishing & Modern Lacquer Finishes  
Re-Upholstery (Quality fabrics at Trade Prices)

**Jon Porter**

Providing a Friendly Local Service for almost 20 years  
Free Advice and Quotations Provided

Tel. 01223 835515 Mob. 07932 611184  
email - traditionaljon@live.co.uk

### Dry Cleaning & Laundry

- Dry Cleaning
- Curtains
- Repairs & Alterations
- Leather & Suede
- Wedding Dresses
- Rug Cleaning
- Ironing Services
- Laundry



143 Milton Road Cambridge CB4 1XE  
01223 755 180 www.FarthingsCambridge.co.uk

### ARCHITECTURAL DRAWINGS

FOR

PLANNING & BUILDING REGULATION APPLICATIONS  
EXTENSIONS, ALTERATIONS, LOFT CONVERSIONS ETC

CONTACT US now to arrange a **FREE** on-site meeting at  
your convenience to discuss your project

**01353 649649**

mail@elydesigngroup.co.uk

**ELY DESIGN GROUP**

www.elydesigngroup.co.uk

### LM Groundworks & Landscaping

- ❖ Patios
- ❖ Paving
- ❖ Footings
- ❖ Drainage
- ❖ Fencing
- ❖ & more

Tel: 01638 743627 / Mob: 07934 642716



Specialists in Wood Flooring,  
Carpets & Vinyl Flooring Solutions

**QUALITY FLOORING SUPPLY,  
INSTALLATION & AFTERCARE**

*"What a fantastic company. Knowledgeable and friendly staff and quality services. My company has used Art of Flooring on a number of occasions already and have been delighted with the whole experience. Thoroughly recommended and future projects will be coming your way." Mr Andy Ward, Cambridge*

141 Milton Road Cambridge CB4 1XE  
01223 755 802 www.ArtofFlooring.co.uk

## CODEWORDS

Each number 1-26 represents a different letter of the alphabet. Can You work out which is which ? Use your word skills and the clues included. Note that Codewords can include names or well-known phrases.  
Answers on page 7 in this magazine.

7	15	2	1	1	20		5	26	6	1	14	19
9		7		9		19		6		21		15
14	2	4	16	18	15	11		9	12	16	11	2
18		16		25		6		1		19		2
2	24	13	11	20		7	6	12	11	2	22	11
4		19				17		2				19
	15	2	21	11	15		25	20	23	21	20	
9				15		3				24		21
13	4	21	11	2	21	9		7	4	21	19	19
4		7		21		21		6		10		11
21	25	6	9	11		16	12	8	6	16	7	2
12		1		1		4		2		12		1
14	16	12	12	2	1		14	1	21	18	6	12

A	1	14
B	2	15
C	3	16
D	4	17
E	5	18
F	6	19
G	7	20
H	8	21
I	9	22
J	10	23
K	11	24
L	12	25
M	13	26
N		
O		
P		
Q		
R		
S		
T		
U		
V		
W		
X		
Y		
Z		

## WORDSEARCH – Nice weather for messing about in Boats !

Can you find all these words in the grid ? They can read left to right, right to left, Up or Down or Diagonally. Tick them off as you go.

N	J	S	L	A	S	A	R	E	K	C	O	L
D	E	C	K	P	A	S	T	E	E	H	S	I
N	T	V	L	I	G	H	T	S	W	T	S	F
E	R	I	E	H	W	F	J	H	A	F	T	E
Z	A	E	L	S	I	O	I	R	N	O	R	L
Z	N	S	T	L	U	T	B	E	O	R	A	I
I	S	E	F	S	E	O	E	T	E	W	P	N
M	O	P	A	O	A	R	H	N	L	A	H	E
A	M	O	R	R	G	M	O	L	E	R	C	A
L	R	R	D	T	R	O	P	R	E	D	T	D
L	I	A	R	O	H	C	N	A	K	E	A	N
B	O	A	T	C	A	S	K	E	T	C	H	I
O	A	R	S	T	A	N	C	H	I	O	N	W

- AFT      JIB      RAIL      WET
- ANCHOR    KEEL    RED      WHEELHOUSE
- ASTERN    KETCH   RIB      WHITE
- BOAT      LASAR   ROPES    WIND
- BOW      LIFELINE   ROW      TAR
- CASK      LIFT      SAIL      TILLER
- CAT      LIGHTS    SCHOONER    TOOTH
- DECK      LOCKER   SHEETS    TRANSON
- DRAFT      MALL      SHIP
- FORWARD    MAST      SKI
- GREEN      MIZZEN    STANCHION
- HATCH      OARS      STARBOARD
- JET      PORT      STRAP

**C & C BLINDS**  
www.freewebs.com/candcblinds

**SPECIALIST MANUFACTURERS OF:**

- Vertical Blinds
- Roller Blinds
- Dutch Blinds
- Venetian, Wooden, Pleated, Roman
- Awnings
- Cleaning Service

any size, any colour  
free measuring & fitting  
shop in the comfort of your own home. FREE ESTIMATES

email: colincoleman64@hotmail.com  
tel: 01223 211171  
mobile: 07761 262070

**M&M**  
Heating & Building Services

- Full Gas Boiler Installation
- Full Heating Systems
- Boiler Servicing and Landlord Certificates
- Power Flushing
- Full Bathroom Design and Installation
- All Plumbing Works Large and Small
- Extensions, Alterations and Repairs
- Refurbishment and Renovations
- Kitchen Design and Installation
- All Carpentry Works
- All Building Works Undertaken
- Painting and Decorating

**01223 691599**  
Mob: 07766 281962/07832 261791  
info@mandmheating.co.uk • www.mandmheating.co.uk  
10 SOUTH ROAD, IMPINGTON, CAMBS. CB24 9PB

**ARTISAN LANDSCAPES**  
Est. 1988

www.artisanlandscape.co.uk

Paving, Fencing, Pergolas, Ponds, Pruning, Structures etc

jonathan\_ashman@hotmail.com  
07768 821354

 Jonathan Ashman Artisan Landscapes

**A. P. GROUNDWORKS**

Block Paving • Patios  
Driveways • Slab Laying  
Groundworks • Drainage

20+ years experience • Free Quotations  
CPCS • CSCS • CITB qualified

Telephone Andy:  
07944 813367 / 01223 233754  
email: apascoe44.ap@gmail.com 

**Shaun's Newsagents**

**Newspapers and magazines direct to your door**

Shaun's News is Cambridgeshire's largest provider of door-to-door newspaper and magazine delivery service with a tailored and rapid solution to the needs of our clients, both residential and commercial. We deliver Newspapers to over 1400 customers in and around Cambridge (ca. 350 customers in Girton).

**What Newspapers and magazines can you supply?** We supply a wide range of local, national and international papers and magazines.

**Newspaper/magazine delivery times?** We start from 06:00 am and aim to finish all newspaper deliveries by 8:30am on weekdays and 9:00 am at weekends. However, most of our customers will receive their papers much earlier.

**How much do you charge for delivery?** We keep our delivery charges to an absolute minimum. To find out the service charge in your area please call or email us your order and address. Our delivery fees are extremely competitive and tailored to your needs. You can stop and re-start deliveries as often as you require.

**How do I pay my bill?** Our standard and preferred method of payment is direct debit. We also accept vouchers, payment over the phone with a credit or debit card, by bank transfer or in person by visiting our office. **If you have a subscription, we accept all vouchers and can apply them to your account in advance. In which case, you will not be charged for papers they represent.**

**Billing frequency?** Our system will generate automatic invoices and email them to you monthly. In the absence of an email address, you will receive a printed copy of your bill with your paper.

**For enquiries, please contact us:**  
Address: Shaun's News, Unit 13, Ronald Rolph Court, Wadloes Road, Cambridge, CB5 8PX  
Email: [shaunsnews@gmail.com](mailto:shaunsnews@gmail.com) Telephone: 01223-650-777



## Girton WI

On Wednesday the 1 April, Rachel Meller came to the WI to give us a talk on her book, "The Box with the Sunflower Clasp." Rachel explained that she knew very little of her family's past until her Aunt Lisbeth left her a cabinet in her will. Within this cabinet she found a box fastened with a Sunflower clasp with many documents, letters, and photographs, that Rachel had not seen before.

Fascinated by this she started researching her family's history and then began to put a book together which took her four years to complete.

Rachel was never very close to her Aunt Lisbeth, rather an unemotional woman with a drawling Viennese Californian accent. Rachel discovered that Lisbeth had been a Jewish teenager growing up in elegant Vienna, caught up by war, and had been forced to flee the city to make a new home in Shanghai. Approximately 20,000 Jews fled and were saved by their move.

Lisbeth and her family left Trieste for Shanghai by ship; the journey taking approximately four weeks. Shanghai in those days was a city of two halves, one of fabulous wealth and one of dreadful poverty. The refugees were made very welcome in Hongkew, the area of real poverty. Rachel also mentioned that the climate was crushingly cold in winter and extremely hot in summer. Undeterred by their new surroundings, the Jewish people started carving out their own lives; by renting property from the locals, starting schools, bakeries, book shops, and many other businesses. They did well and were popular with the Chinese people.

Rachel did not tell us if Lisbeth found love in her new adopted home, she advised us that we would have to buy the book to uncover the ending! She did however inform us that Lisbeth went to work in the Jewish bookshop – so maybe she found love amongst the bookshelves. We must consult the book to find out.

Rachel read out lots of parts of her book. She was very excited to tell her WI audience that she had been Shortlisted for the Royal Society of Literature Christopher Bland Prize 2024 (for info: The book is also available in audio).

We had a short question and answer time, thanked Rachel very much for her attending and letting us have a taster of what sounds a very well researched and interesting insight into a very difficult time in recent history.

*Meryl Burt*

## Early Birds WI

We were given a talk by historian Honor Ridout during our meeting on 10 April. This included detail on Christ College founded by Lady Margaret Beaufort, with her statue over the entrance to the college, and a place where a young Charles Darwin studied. A young Darwin bronze statue lies within the college, plus a plaque near Boots where he lodged.

Onto the quayside which was a busy inland port used for carrying goods to the city and Magdalene College that houses

the entire works of Samuel Pepys, including an original drawing of the Mary Rose. The column opposite St Giles' church had to be removed in order for up to date work and digging there found hundreds of gold and silver coins from the 1300's. Finally to the plaque at Corpus Christi, recognising Rosalind Franklin, who as well as Crick and Watson, was instrumental in her findings on DNA.

Early Birds meet every second Friday in the month at 10.30am in the Federation office between Girton and Oakington. *Gillian Taylor*



*"Where words fail music speaks"....*  
(Hans Christian Anderson)

### Tuesday 19 May

Club 55 will be hosting an afternoon of tea, coffee, and cakes at Abbeyfield restaurant, with live flute music provided by flautist Brenda Dykes. The event will start with refreshments being served at 2.45pm. The cost for refreshments is a £5 card payment, paid directly to Abbeyfield on the day. A voluntary collection will be made to top up Club 55 funds which help us to organise these events. Those of you who attended the previous event where we had a visiting harpist, will recall how we left the venue with a feeling of serenity. Please let me know via email or phone if you intend to come - we will need to know before 12 May.

At the time of writing this article we have not had our Club 55 meal at Girton Golf Club, but I can report that the uptake has been very encouraging and I am certain, by the time you read this article, we will have had a good time together. It is very encouraging to have these events so very well attended.

### Tuesday 16 June

Our next date for our Club 55 film, showing at the William Collyn Community Centre (WCCC). The last few films seem to have gone down well, so I am hopeful many will also enjoy this one...however, there is a sad bit so please bring a tissue. "Finding Your Feet," is described as "a brilliant British comedy," it stars Imelda Staunton, Timothy Spall and Celia Imrie, David Hayman, John Sessions, and Joanna Lumley.

With such a cast you know you are in for some very good acting. The basic story line is that when Lady Sandra Abbot (Imelda Staunton), discovers her husband is having an affair, she seeks refuge with her estranged bohemian sister, Bif (Celia Imrie), and so the story begins with fun, laughter and a few tears of both joy and sadness along the way. With some very uplifting moments I hope this film provides us with an enjoyable afternoon shared with friends.

Doors open at 1pm and refreshments will be served prior to the film starting at 1.30pm. The cost is £5, paid directly to the WCCC, which covers the cost of the hall and the license for showing the film. Club 55 appreciates any small contribution towards refreshments. Please do not arrive before 1.00pm as we will still be setting up the hall.

Please let me know in advance if you are coming to the film so we can provide enough seats and refreshments.

*patdickensclub55@gmail.com*  
01223971596 (answerphone message)



## The Friends of the Rosie

We would like to thank all of our customers for their continued support. With your help we have raised £1,245 so far in 2026 to help make the Rosie a more comfortable environment for mothers and babies. You can find out below how we spent your donations in 2025.

### Report of the Annual General Meeting on Monday 2 March

We would like to thank Avril for all her hard work with Rosie in Stitches and doing stalls around the community. The committee try to support her with these.

We have just had kind donations of £500 from PEM and £210 from a Crib Drive which took place at the British Legion in Histon. The winner chose a charity and this lady recently had a granddaughter born at The Rosie.

The total expenditure in 2025 was £23,906.46, including purchasing a scanner for £26,400, and total income was £5,484.74.

### Rosie in Stitches

Rosie in Stitches has lots of crafters making items for the wards at the Rosie Hospital as well as selling items at village markets and online. We had stalls at 10 community markets. Lots of customers chatted with us about themselves or their babies being born in the Rosie.

We have put more articles in the blog section of our website. If you have an article to include, please get in touch.

We were approached on behalf of students who would like to help by knitting, crocheting and sewing for their Duke of Edinburgh Award challenge.

One of our customers bought cardigans to embroider designs onto them.

One of our regular customers commissioned some more items. Other commissions in 2025 were a baby blanket, three pairs of trousers and another dog coat. Special thanks to Anna and Tara for raising £130 and Sue, Pat and Avril for completing the several commissions.

We entered our Foot Loose and Fancy Tree at the Landbeach festival in November and the Stapleford festival in December.

We raised £1,270, making £820.81 after expenses for insurance, online fees, postage, mobile phone contract and Sumup machine fees.

We are benefiting from having an online presence, where donations at the checkout via PayPal brought in £12 and via Benevity where we received donations of nearly £95.

We have nearly two thousand second-hand items for sale on our Ebay store rosieinstitches2010. We've just received our 15th anniversary badge with eBay. Other eBay members are selling items to benefit the charity.

We have items of clothing and toys for sale on our website [www.rosieinstitches.org.uk](http://www.rosieinstitches.org.uk)

### Requests for purchases

The community nurses would like us to purchase 8 iPads which would enable them to write notes as they are talking to their patients rather than having to hand write notes to be typed up later in the day. Writing the notes while with the patient would both save time and improve accuracy and aligns with the digital responsibilities of the Trust. Total estimated cost will be up to £8,000.

A lot of work for the bereavement services is being carried out now such as decorating rooms, building en-suites etc. They may come back to us later for items like tea and coffee facilities.

Improvement works going forward include transitional care (which would create a half way house between birth and neonatal care) plus trial of induction in the Birth Centre for mums who are post birth date and low risk.

### Finally...

Knitted hats are still wanted – red, green, yellow but they must be good newborn baby size not too small and easy to pull on. These could be left with Christina on main reception or Tara receptionist in the Birth Centre.

Thank you for your continued support.

*Avril Williams*



## GIRTON Parish News

## How you can support the GPN

We are continuing to offer our readers the chance to make a regular financial contribution to the GPN. This could just be £5 or £10 a year, or more if you felt comfortable doing so.

How can you donate?

1. **Online banking** - the GPN bank details are as follows:

Sort code: 60-04-23

Account number: 54490391

Account name: Girton Parish News

2. **Cheque** - these can be posted to our Treasurer Marion Fisher at 117 High Street, Girton, CB3 0QQ.

3. **Get in touch** – if you need help donating then contact our Secretary Sheila Bowler on 01223 276914.

The GPN provides a unique insight into what goes on in our precious village and we are hopeful that with your valued support we can continue to document life in Girton for years to come.

*Rob Neal, Editor*



## Encouraging signs

Sometimes we see hope and positivity around us with ease and readiness. We may notice encouraging signs in nature, in the kind acts of others, in people’s words or in how we feel about ourselves. It’s almost

like a magnet – we notice one thing and then another and then another, without effort or intention.



But at other times, the troubles of the world, local community conflict and personal problems or challenges can hinder our ability to see the positive or even to seek encouraging signs. It’s in times like this that the support of others may be needed, that we may have to be intentional about gratitude or that we are wise to act in seeking small encouraging signs. One of the ways I do this is by taking a walk (it could be a ten-minute walk, a lunchtime stroll, or a weekend wander) with the intention of taking photographs of aspects of nature: blossom, buds, birds, insects; or by looking up, looking down, and looking under.

So, I hope you enjoy these accompanying images from our village, taken on various occasions over the last month which have been part of my proactive approach to seeking encouraging signs.

### Signposting

Engaging in volunteering not only has the benefit of helping others, but it is also part of ‘giving’ which is one of the Five Ways to Wellbeing – supportive of our own mental and physical health. There are organisations which can guide you to opportunities (see below) but why not start on your own doorstep, in your own neighbourhood?

Find Out More: [www.volunteercambs.org.uk](http://www.volunteercambs.org.uk)

### Inclusive training

Course evaluations sometimes pose questions about how inclusive the training has been. What is even more satisfying is when a learner provides feedback without such a prompt:

“Juliet’s teaching style was brilliant! I generally have a very short attention span and sometimes find classroom training quite tricky, but she kept me fully engaged for both days. Where there were trickier questions or challenges to Juliet from the group, she answered them clearly, gave several examples for her reasoning and really engaged with the person.”

*Juliet Adloune, a longstanding Girton resident, is a fully qualified and accredited Adult Mental Health First Aid Instructor and Suicide First Aid Associate Tutor experienced in delivering the full suite of MHFA and SFA courses and committed to supporting mental health within her local community. Contact her via: [www.facebook.com/listeninglantern.julietadloune](http://www.facebook.com/listeninglantern.julietadloune) or [mhfa.julietadloune@gmail.com](mailto:mhfa.julietadloune@gmail.com)*

## Girton Walking Group

### Saturday 4 April

#### A Walk from Bar Hill

A very pleasant walk from Bar Hill into Dry Drayton and Rectory Farm. The last meadow dropped down towards the church.



### Saturday 9 May - The walk begins in St Ives

We park at the Leisure Centre, Postcode PE27 6WU at the lower end of the car park. A dry path takes us all the way to the Mill at Houghton where there is a café or a seat where you can eat your own snacks. Facilities are also available. We cross the Great Ouse here and walk through the two Hemingford villages back to the ancient bridge in St Ives. The last part is a flood meadow so could be wet if rain has fallen recently. 5 to 6 miles in all but all comfortable walking.

### Saturday 6 June - Wicken Fen

This walk skirts the National Trust Reserve at Wicken Fen cutting across to Wicken Lode, a channel probably dug by the Romans. The walk is approximately 4 miles long but may be slow due to the uneven ground, please wear sturdy walking shoes. The Fen is a lovely opportunity to see what the landscape looked like before the fens were drained for farmland.

Please meet at the Wicken Fen car park CB7 5XP at 10am. National Trust members can park for free so please could those of you with membership please bring your cards with you. There are usual facilities at the car park.

This walk is being led by Elisabeth Kron and Rachel Thomas. If you need a lift or would like to join our mailing list for future walks or if you no longer wish to receive members emails, please contact me at [ann.jerram@gmail.com](mailto:ann.jerram@gmail.com). Note that all walks are at your own risk.

## Tribute to Louie Holliday

Some of you will have known Louie Holliday as the plasterer in the village, others from the George pub, and many as a genuine friend who was always pleased to see you. Louie was a devoted husband to Jackie, and a much-loved father to Zoe, Jade and Milly.

It is with great sadness that we share that he passed away peacefully on Saturday 11 April, with his wife and three daughters by his side.

As a family, we would like to thank the residents of Girton, the customers of *A Complete Plastering Service*, and the many valued friendships formed over the past 19 years.

Girton meant a great deal to Louie. He found peace in the walks, the people, and the strong sense of community. A skilled craftsman with over 45 years of experience, he took great pride in his work. His dedication and perfectionism meant that many of his customers became lifelong friends.

We hope he will be remembered for his great sense of humour, his storytelling, and his warm, friendly nature.

Thank you to the people of Girton for your kindness, support, and friendship over the years. Please raise a glass to Louie at the next sunny sunset.

With best wishes  
*The Holliday Family*



## Girton Art Exhibition 2026



### St Andrew's Church, Girton

Friday 8<sup>th</sup> May 10 am to 7 pm  
Saturday 9<sup>th</sup> May 10 am to 5 pm

- Free entry
- Greetings cards
- Refreshments available



[www.girtonartshow.org.uk](http://www.girtonartshow.org.uk)



## The Lawrence Room at Girton College

Girton College's one-room museum of antiquities houses Anglo-Saxon and Roman material excavated from the site when the college was built, and other items donated to the college through the 20th century, including the famous Roman portrait mummy, *Hermionē Grammatikē*. The collection today ranges from Egyptian material, Roman coins and Tanagra statuettes to Mesopotamian eye-idols, and items from China and New Zealand.

Now open all Sundays, 1.30pm - 2.30pm, up to 28 June with student curators, as well as Thursdays 2-4pm year-round with alumni curators. Girton's antiquities museum welcomes families to view its locally excavated finds, as well as Egyptian, Mediterranean, and Far Eastern donated objects. A children's treasure-hunt-style leaflet is available as well as a brief room-guide to take away. At any time of year, you are also welcome to use the 'Social Hub' ground-floor cafe on site, wander around the People's Portraits collection on long-term loan to the college and walk around the woodland trail: dogs on leads are welcome.

<https://www.girton.cam.ac.uk/about-girton/art-artefacts/lawrence-room>



## St Andrew's Church

**Rector:** Revd Michael Bigg (*rector@girton.church*)  
Tel: 01223 202145; Website: *www.girton.church*

**Associate Priests:**

Revd Christine Barrow (*mcbarrow@me.com*)  
Revd Marie Lucchetta-Redmond (*marie@girton.church*)

**Curate:** Revd Kevin Parks (*curate@girton.church*)

**Licensed Lay Ministers:** (*llm@girton.church*)

**Children and Families Minister:** Dr Eona Bell

Tel: 07305 201419; (*cfm@girton.church*)

**Anna Chaplains:** (*anna@girton.church*)

**Churchwarden:** (*wardens@girton.church*)

**Sunday Services: May**

- 3<sup>rd</sup>     **10:00am** - Holy Communion (+ activities for children)  
          **7:00pm** - Contemplative/Reflective Service
- 10<sup>th</sup>    **8:00am** - Holy Communion (BCP)  
          **10:00am** - All-Age Communion  
          **6:00pm** - Evening Prayer (BCP)
- 17<sup>th</sup>    **10:00am** - Holy Communion (+ activities for children)  
          **6:00pm** - Evening Prayer (BCP)
- 24<sup>th</sup>    **8:00am** - Holy Communion (BCP)  
          **10:00am** - Morning Prayer  
          **5:30 pm** - St Andrew's Youth Group
- 31<sup>st</sup>    **10:30am** - Joint service in Madingley (+ activities for children)

**Regular weekday Services: May**

<b>Tues</b>	<b>9am</b>	Morning Prayer (said)
<b>Weds</b>	<b>9am</b>	Morning Prayer (said) (Online)
<b>Thurs</b>	<b>9am</b>	Morning Prayer (said) (Online)

**Other Services**

- 13<sup>th</sup>    **2:00pm** - Abbeyfield, Ecumenical Holy Communion
- 14<sup>th</sup>    **6:00pm** - Ascension Day celebration
- 19<sup>th</sup>    **2:45pm** - Arlington Manor, Ecumenical Holy Communion
- 28<sup>th</sup>    **11:00am** - Gretton Court, Holy Communion (BCP)

There will be no morning service in Girton on 31 May. We join our friends in Madingley at 10:30am with a service of Holy Communion at which Alex Hughes, Archdeacon of Cambridge, will preach. There will be activities for children.

On the 14 May we celebrate Ascension Day, 40 days after Easter. The day when Jesus ascended into heaven. Please join us at 6pm. Weather permitting, we will have a symbolic rocket from the churchyard! For information about all these events please see the church website. You are welcome to join us for Sunday morning worship in person or remotely at <http://bit.ly/GirtonParishLive>. Please check the church website for up-to-date information. ( *www.girton.church* )

**Prayer**

God our Father, make us joyful in the ascension of your Son Jesus Christ. May we follow him into the new creation, for his ascension is our glory and our hope. We ask this through our Lord Jesus Christ. [*The Liturgy of the Hours*]

**From the Registers: Funerals**

31 <sup>st</sup> March	Arthur Wilman
8 <sup>th</sup> April	Pauline Ford

## Girton Baptist Church



**Minister:** Revd Nick Lowe  
**Church Tel:** 07483 334860  
**Church Secretary:** Mrs Virginia Rootham-Smith  
**Tel:** 01223 520442

**Website:** *www.girtonbaptistchurch.org.uk*

**May Services at Girton Baptist Church**

- 3<sup>rd</sup>     Morning Service with Communion, at 10.30am
- 10<sup>th</sup>    Morning Service, at 10.30am
- 17<sup>th</sup>    Morning Service with Communion, at 10.30am
- 24<sup>th</sup>    Morning Service, at 10.30am
- 31<sup>st</sup>    Open Service, at 10.30am

**Other Events**

- Coffee Morning: Would you like a chat and coffee on a Thursday morning? Why not try our friendly Coffee Morning at Girton Baptist Church from 10am?
- Tuesday Afternoon Friendship Group: TAF this month will be a Quiz on 5<sup>th</sup> May at 2:15pm. All are welcome.

We warmly invite you to join our Bible study, at present on the book of Revelation. Whether you're curious about the Bible or wish to delve deeper into the Christian faith, please don't hesitate to contact us. We would be delighted to share more information with you.

All are welcome to the services and events that we provide.

For further details about any of the above, including the online Zoom link for any of the services, please ring 07483 334860 or email *secretary@girtonbaptistchurch.org.uk* or *pastor@girtonbaptistchurch.org.uk*

**A Short Devotion**

The month of May is when everything in our gardens and in the countryside seems to wake up. Yet, as we know, the real work of growth has been happening, quietly, silently, long before we noticed anything at all.

Jesus once said that the kingdom of God is like a seed growing in the ground that, "sprouts and grows; he knows not how." (Mark 4:26-27)

Even though modern science has explained many of the mechanisms that cause seeds to grow, it remains somewhat of a mystery. And this hidden growth is still an honest picture of the spiritual life. Most of God's work in our lives is slow, steady and hidden, and we don't always notice it. Perhaps the month of May gives us space to be open to whatever quiet, renewing work God may be doing in us.

**If you would like to discuss any Parish Council issues, please contact the following:**

**Chair**

Stuart Marshall, [stuart.marshall@girton-pc.gov.uk](mailto:stuart.marshall@girton-pc.gov.uk)

**Vice-Chair**

Daniel Carney, [daniel.carney@girton-pc.gov.uk](mailto:daniel.carney@girton-pc.gov.uk)

**Councillors**

Archie Bajpai, [archie.bajpai@girton-pc.gov.uk](mailto:archie.bajpai@girton-pc.gov.uk)

Victoria Brown, [victoria.brown@girton-pc.gov.uk](mailto:victoria.brown@girton-pc.gov.uk)

George Crawley, [george.crawley@girton-pc.gov.uk](mailto:george.crawley@girton-pc.gov.uk)

Martin Dickson, [martin.dickson@girton-pc.gov.uk](mailto:martin.dickson@girton-pc.gov.uk)

Nas Hayat, [nas.hayat@girton-pc.gov.uk](mailto:nas.hayat@girton-pc.gov.uk)

Patrick Linton, [patrick.linton@girton-pc.gov.uk](mailto:patrick.linton@girton-pc.gov.uk)

Ann Muston, [ann.muston@girton-pc.gov.uk](mailto:ann.muston@girton-pc.gov.uk)

Richard Reeves, [richard.reeves@girton-pc.gov.uk](mailto:richard.reeves@girton-pc.gov.uk)

Walter Richards, [walter.richards@girton-pc.gov.uk](mailto:walter.richards@girton-pc.gov.uk)

Con Tasioulas, [con.tasioulas@girton-pc.gov.uk](mailto:con.tasioulas@girton-pc.gov.uk)

**Formal correspondence to the Council should be addressed to the Parish Clerk.**

**District Councillors**

Corinne Garvie, Tel: 07780 932267

[cldr.garvie@scambs.gov.uk](mailto:cldr.garvie@scambs.gov.uk)

Richard Stobart, Tel 07950 934793

[cldr.stobart@scambs.gov.uk](mailto:cldr.stobart@scambs.gov.uk)

**County Councillor**

Edna Murphy, Tel: 01223 577005

[edna.murphy@cambridgeshire.gov.uk](mailto:edna.murphy@cambridgeshire.gov.uk)

**Parish Clerk and Finance Officer**

Yvonne Murray Tel: 01223 618619

[clerk@girton-pc.gov.uk](mailto:clerk@girton-pc.gov.uk)

**Facilities Manager**

Angie Vidler, Tel: 01223 618619

[admin@girton-pc.gov.uk](mailto:admin@girton-pc.gov.uk)

**Website:** [www.girton-pc.gov.uk](http://www.girton-pc.gov.uk)

**Postal address**

Girton Parish Council

The Pavilion, Girton Recreation Ground

Cambridge Road

Girton

Cambridge

CB3 0FH

*(Contact details correct at time of publication. Councillor roles and contacts may change following the 7 May 2026 elections. Please check the Parish Council website for the latest information.)*

**You can also use these QR codes to contact us:**



Girton Parish Council Website



Girton Village Community FB



Girton PC Twitter @GirtonPCouncil

**Bin collections April/May**

Thursday 30 April Blue and Green bins

Thursday 7 May Black bin

Thursday 14 May Blue and Green bins

Thursday 21 May Black bin

Thursday 28 May Blue and Green bins

*\*Please note food caddy collections start every Thursday from 14 May.*

**Mobile library**

**Thursday 28 May**

Thornton Court 9.40-10.00am

Abbeyfield 10.10-10.50am

Cotton Hall/Church 11.00-11.30am

Orchard Close 11.35-11.55am

St. Vincent's Close 12.00-12.40pm

Gretton Court 12.50 - 1.15pm

Churchfield Court 1.20 - 1.45pm

**Contact numbers for bookings**

Cotton Hall 07759 983420

Orchard Close 277164

Pavilion 618619

St Vincent's Close 276447

William Collyn Centre 279587



**Girton Mobile Post Office**

The van visits Girton on Fridays between 1.30-2.30pm in the car park behind the Girton Village Day Nursery on Cambridge Road/Orchard Close.

It offers most of the usual post office services: sending parcels, buying stamps and withdrawing cash but it does not have forms for the DVLA, TV licences and passports

More information can be found by typing "Mobile Post Office Girton" into a web search engine, which will also state if the mobile van will not be there on a particular date; or you can go to the "Mobile Post Office Van Cambridgeshire" Facebook page. A notice will also be on display in the van in advance of any closed day.

**PODMORE**  
GARDENING &  
HANDYMAN SERVICES

EST 2025

Reliable help for every  
hedge and hallway  
One name for every job  
— indoors and out  
Gardens trimmed  
Homes maintained

**Podmore delivers**

CONTACT: NIK 07793 037556 OR  
NIK@PODMORESERVICES.CO.UK

**Cat & Dog Drop-in Visits**

**Group & Solo Dog Walks**

- ✓ Complimentary Meet & Greets
- ✓ Full Insured & DBS Checked
- ✓ Pet First Aid & CPR Trained

**Contact Me**  
07752 934858  
Covering Cambridge, UK  
and surrounding areas

Nicol's Cat and Dog Sitting Services  
Nicols.CDSS

**Cambridge Building Services**  
conserve, protect, restore

A family run business for all your building  
and property maintenance needs.

Our services range from extensions, conversions and knock through's to  
windows, doors, brick and stone repairs.

Servicing domestic and commercial premises in Cambridge and  
surrounding villages.

hello@cambridgebuildingservices.co.uk

07943 276122

01223 956545

LEARN HOW  
TO WEAR  
COLOUR  
CONFIDENTLY.

HOUSE OF COLOUR

**HOUSE of COLOUR**

Discover your best colours and your unique style!  
Colour Analysis and Style Consultations available in Girton

WWW.HOUSEOFCOLOUR.CO.UK/STYLISTS/SARAH-GEORGE-LEE  
07790 635815

**• PAINT • DECORATE • DESIGN •**

Full decorating and Painting service  
Wallpaper removal  
Design ideas and advice  
Free estimates

Joanne Harmer  
Telephone: 01223 277012  
Mobile: 07787 068987  
joanne.m.harmer@gmail.com

**Professional Knife Maker  
and Sharpening Service in Girton**

I can sharpen all knives, secateurs, shears, kitchen  
scissors, loppers, axes, mattocks, spades etc,  
and make bespoke knives.

**Contact: 07989 412908**  
(It's best to text me if you want a prompt reply)

**Matthew Courtney-Jones**

**MOTUS PHYSIOTHERAPY**  
SIMPLE AND EFFECTIVE

Chartered Physiotherapists | In Girton | Ample Free  
Parking | Home visits | Accept Private Medical Insurance  
and Self Funders

Online consultations via telephone, Skype or Face Time  
available

**01223 949405**

W: www.motusphysiotherapy.co.uk  
E: info@motusphysiotherapy.co.uk

Vision Fitness, Oakington Road, Girton, CB3 0QH

# Belly rubs come as standard.



We know certain things make home feel like home.

So if you've got a four-legged friend you'd like to bring along, we'll do everything we can to make them feel welcome too.



Every moment.



**HALLMARK**

LUXURY CARE HOMES

Residential, nursing and dementia care.

---

Learn about life with us at

[hallmarkcarehomes.co.uk](http://hallmarkcarehomes.co.uk) | 01223 080 138 | Hallmark Arlington Manor, Girton, CB3 0FW